

9209 Duct Blower - Part# 9020033

| Part Number | Description | Qty Required | Dimensions | | | |
|-------------|---|--------------|------------|----------|---------|-------|
| | | | A | B | C | D |
| R-6030003 | Wheel, G9BD-46-3/4-RH-LCD | 1 | 3/4" | 10-1/4" | 9-9/16" | N/A |
| R-2100391 | Shaft, 3/4 X 16-5/16, 2KWY | 1 | 3/4" | 16-5/16" | N/A | 2 KwY |
| R-B-6080002 | Bearing Bracket Assembly, G9 B/B (c/w bearing and sleeve) | 2 | 3/4" | N/A | N/A | N/A |
| R-B-8100000 | Ball Bearing, 3/4" Complete with Rubber Sleeve | 2 | 3/4" | N/A | N/A | N/A |
| R-B-3000069 | 9209 DOOR | 2 | N/A | N/A | N/A | N/A |
| R-B-3180039 | 209 Motor Platform | 1 | N/A | N/A | N/A | N/A |
| R-B-7010033 | Parts Bag,200 SERIES | 1 | N/A | N/A | N/A | N/A |
| R-B-8860014 | Rubber Grommets (#19) | 4 | N/A | N/A | N/A | N/A |

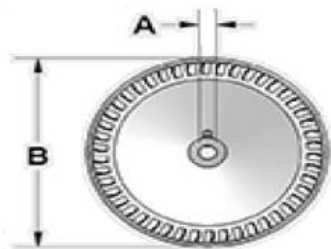

Wheel

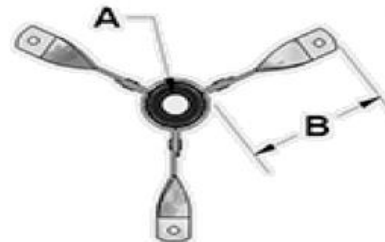
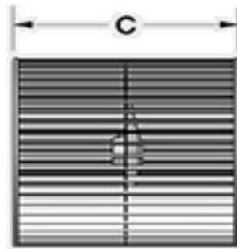

Bearing, Bearing Bracket and Shaft

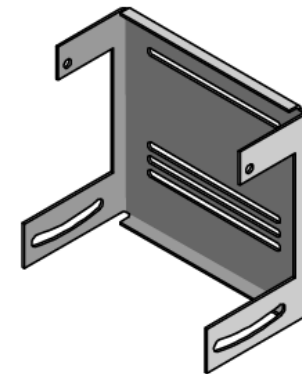
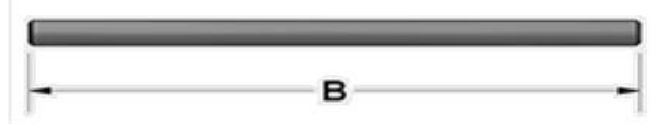

Motor Mount Platform

9209-2 Duct Blower - Part# 9020039

| Part Number | Description | Qty Required | Dimensions | | | |
|-------------|---|--------------|------------|-------------|---------|-------|
| | | | A | B | C | D |
| R-6030003 | Wheel, G9BD-46-3/4-RH-LCD | 2 | 3/4" | 10-1/4" | 9-9/16" | N/A |
| R-2100422 | SHAFT, 3/4 X 38-5/16, 2KWY | 1 | 3/4" | 38-5/16" | N/A | 2 KwY |
| R-B-6080002 | Bearing Bracket Assembly, G9 B/B (c/w bearing and sleeve) | 3 | 3/4" | N/A | N/A | N/A |
| R-B-8100000 | Ball Bearing, 3/4" Complete with Rubber Sleeve | 3 | 3/4" | N/A | N/A | N/A |
| R-B-3000069 | 9209 DOOR | 2 | N/A | N/A <td N/A | N/A | |
| R-B-3180039 | 209 Motor Platform | 1 | N/A | N/A | N/A | N/A |
| R-B-7010033 | Parts Bag, 200 SERIES | 1 | N/A | N/A | N/A | N/A |

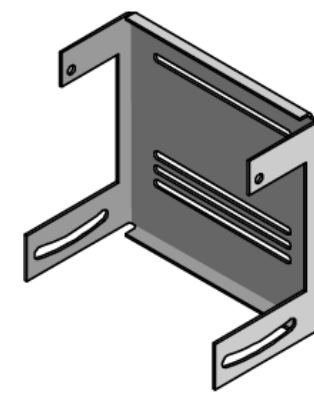
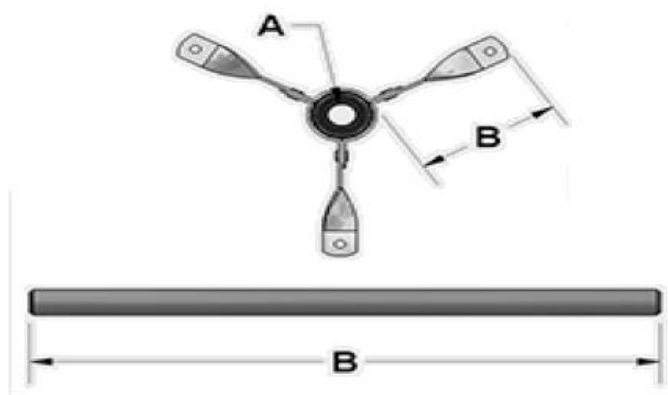
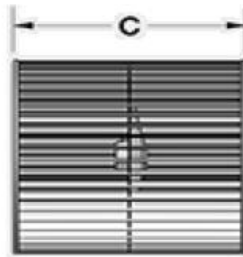
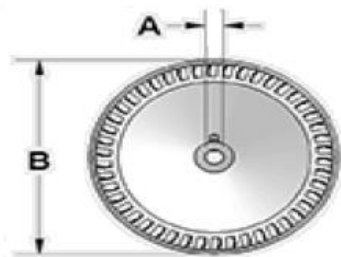

Wheel

Bearing, Bearing Bracket and Shaft

Motor Mount Platform

9210 Duct Blower - Part# 9020034

| Part Number | Description | Qty Required | Dimensions | | | |
|-------------|--|--------------|------------|----------|-----------|-------|
| | | | A | B | C | D |
| R-6030007 | Wheel, G10BD-52-3/4-RH-LCD | 1 | 3/4" | 11-9/16" | 10-13/16" | N/A |
| R-2100392 | SHAFT, 3/4 X 17-5/8, 2KWY(B) | | 3/4" | 17-5/8" | N/A | 2 Kwy |
| R-B-6080003 | Bearing Bracket Assembly, G10 B/B (c/w bearing and sleeve) | 2 | 3/4" | N/A | N/A | N/A |
| R-B-8100000 | Ball Bearing, 3/4" Complete with Rubber Sleeve | 2 | 3/4" | N/A | N/A | N/A |
| R-B-3000075 | 9210, DOOR | 2 | N/A | N/A | N/A | N/A |
| R-B-3180040 | 210 Motor Platform | 1 | N/A | N/A | N/A | N/A |
| R-B-7010033 | Parts Bag,200 SERIES | 1 | N/A | N/A | N/A | N/A |
| R-B-8860014 | Rubber Grommets (#19) | 4 | N/A | N/A | N/A | N/A |

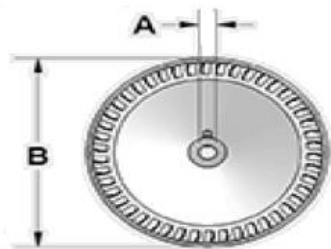

Wheel

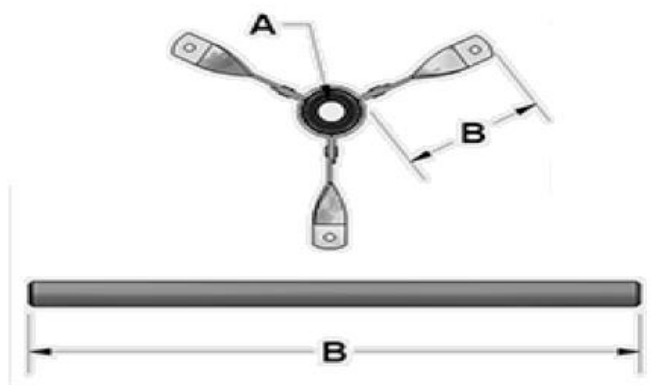
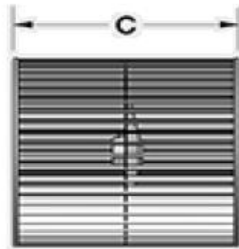

Bearing, Bearing Bracket and Shaft

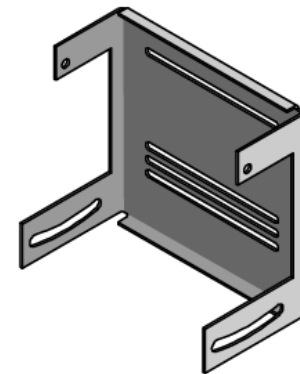

Motor Mount Platform

9212-2 Duct Blower - Part# 9020041

| Part Number | Description | Qty Required | Dimensions | | | |
|-------------|--|--------------|------------|---------|-----------|-------|
| | | | A | B | C | D |
| R-6030018 | Wheel, G12BD-58-1-RH-RCD-LH-LCD | 2 | 1" | 12-7/8" | 12-13/16" | N/A |
| R-2100046 | Shaft, 1 X 54-5/8, 2KWY | 1 | 1" | 54-5/8" | N/A | 2 KwY |
| R-B-6080007 | Bearing Bracket Assembly, G12 B/B (c/w bearing and sleeve) | 3 | 1" | N/A | N/A | N/A |
| R-B-8100001 | Ball Bearing, 1" Complete with Rubber Sleeve | 3 | 1" | N/A | N/A | N/A |
| R-B-3000081 | 9212, Door | 2 | N/A | N/A | N/A | N/A |
| R-B-2181121 | Motor Plate 1-5 HP, (Q) Laser | 1 | N/A | N/A | N/A | N/A |
| R-B-7010012 | Parts Bag, 9212-2 | 1 | N/A | N/A | N/A | N/A |

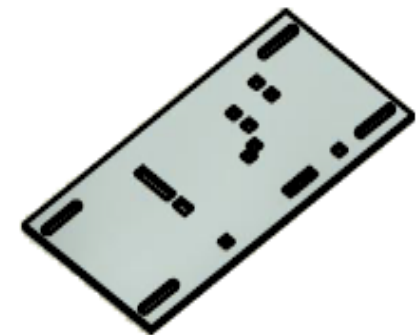
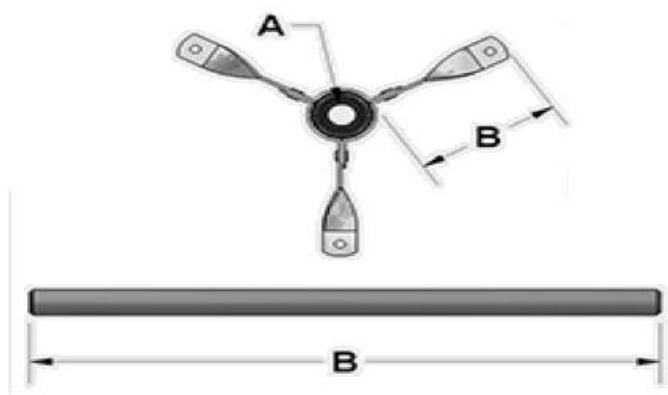
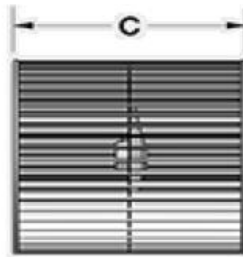
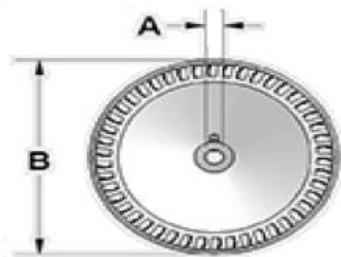

Wheel

Bearing, Bearing Bracket and Shaft

Motor Mount Plate

9215 Duct Blower - Part# 9020036

| Part Number | Description | Qty Required | Dimensions | | | |
|-------------|--|--------------|------------|---------|----------|-------|
| | | | A | B | C | D |
| R-6030028 | Wheel, G15BD-70-1-RH-RCD-LH-LCD | 1 | 1" | 15-1/2" | 15-1/16" | N/A |
| R-2100056 | Shaft, 1 X 25, 2KWY | 1 | 1" | 25" | N/A | 2 Kwy |
| R-B-6080008 | Bearing Bracket Assembly, G15 B/B (c/w bearing and sleeve) | 2 | 1" | 8-3/8" | N/A | N/A |
| R-B-8100001 | Ball Bearing, 1" Complete with Rubber Sleeve | 2 | 1" | N/A | N/A | N/A |
| R-B-2181121 | Motor Plate 1-5 HP, (Q) Laser | 1 | N/A | N/A | N/A | N/A |
| R-B-3000087 | 9215, Door | 1 | N/A | N/A | N/A | N/A |
| R-B-7010012 | Parts Bag 9212/9215 | 1 | N/A | N/A | N/A | N/A |

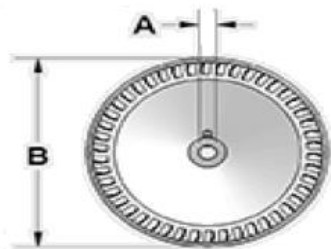

Wheel

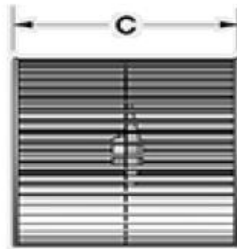

Bearing, Bearing Bracket and Shaft

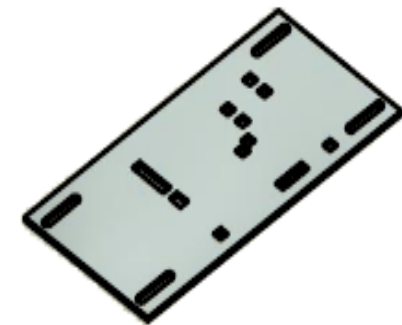
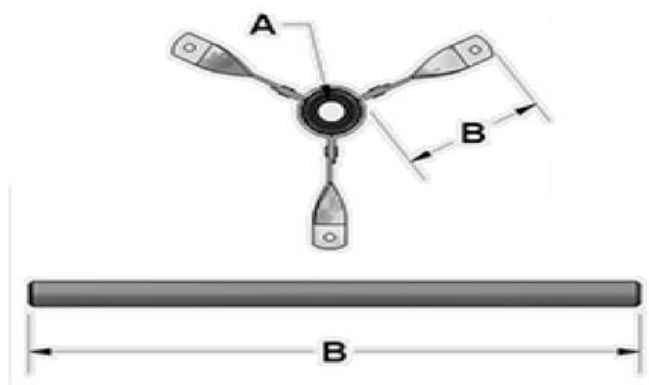

Motor Mount Plate

9215-2 Duct Blower - Part# 9020042

| Part Number | Description | Qty Required | Dimensions | | | |
|-------------|--|--------------|------------|---------|----------|-------|
| | | | A | B | C | D |
| R-6030028 | Wheel, G15BD-70-1-RH-RCD-LH-LCD | 2 | 1" | 15-1/2" | 15-1/16" | N/A |
| R-2100051 | Shaft, 1 X 61-3/8, 2KWY | 1 | 1" | 61-3/8" | N/A | 2 Kwy |
| R-B-6080008 | Bearing Bracket Assembly, G15 B/B (c/w bearing and sleeve) | 3 | 1" | N/A | N/A | N/A |
| R-B-8100001 | Ball Bearing, 1" Complete with Rubber Sleeve | 3 | 1" | N/A | N/A | N/A |
| R-B-3000087 | 9215, Door | 2 | N/A | N/A | N/A | N/A |
| R-B-2181121 | Motor Plate 1-5 HP, (Q) Laser | 1 | N/A | N/A | N/A | N/A |
| R-B-7010012 | Parts Bag 9212/9215 | 1 | N/A | N/A | N/A | N/A |

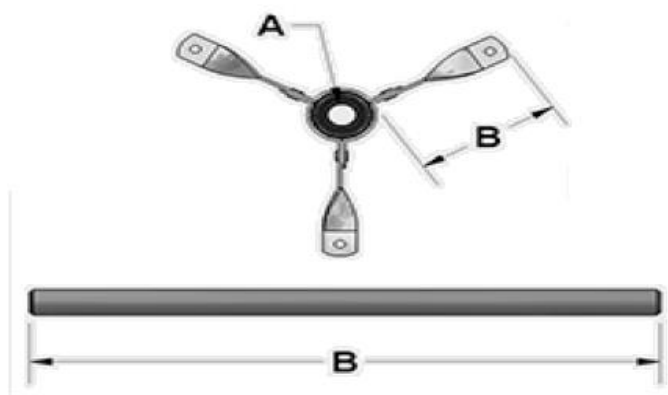
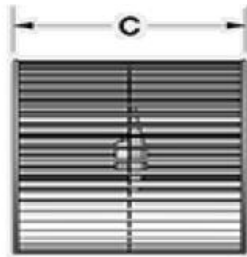
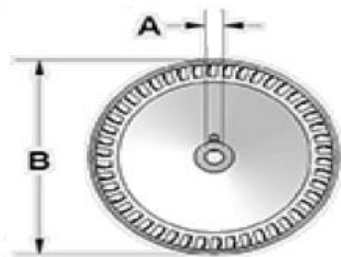

Wheel

Bearing, Bearing Bracket and Shaft

Motor Mount Plate

9218 Duct Blower - Part# 9020037

| Part Number | Description | Qty Required | Dimensions | | | |
|-------------|--|--------------|------------|---------|---------|-------|
| | | | A | B | C | D |
| R-6030031 | Wheel, G18BD-52-1-3/16-RH-RCD-LH-LCD | 1 | 1" | 18-1/2" | 18-1/2" | N/A |
| R-2100052 | Shaft, 1-3/16 X 74-3/4, 4KWY | 1 | 1" | 32-1/8" | N/A | 2 KwY |
| R-B-8100003 | Cast Iron Pillow Block Bearing,1" | 2 | 1" | N/A | N/A | N/A |
| R-B-3000092 | 9218, Door | 2 | N/A | N/A | N/A | N/A |
| R-B-6060014 | 1-15 HP Motor Platform | 1 | N/A | N/A | N/A | N/A |
| R-B-7010025 | Parts Bag, Separate ,1-15HP Motor Platform | 1 | N/A | N/A | N/A | N/A |

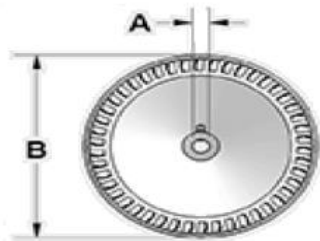

Wheel

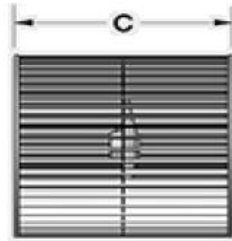

Bearing, Bearing Bracket and Shaft

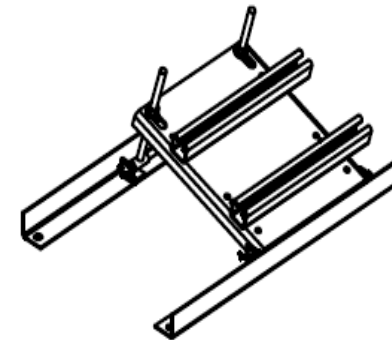
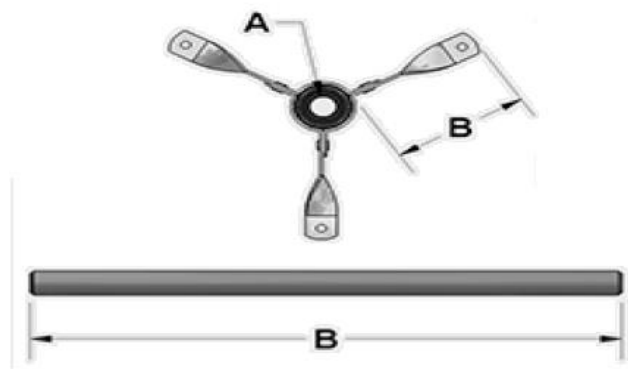

Motor Mount Platform

9218-2 Duct Blower - Part# 9020043

| Part Number | Description | Qty Required | Dimensions | | | |
|-------------|--|--------------|------------|---------|---------|-------|
| | | | A | B | C | D |
| R-6030032 | Wheel, G18BD-52-1-3/16-RH-RCD-LH-LCD | 2 | 1-3/16" | 18-1/2" | 18-1/2" | N/A |
| R-2100252 | Shaft, 1-3/16 X 74-3/4, 4KWY | 1 | 1-3/16" | 74-3/4" | N/A | 4 Kwy |
| R-B-8100004 | Cast Iron Pillow Block Bearing, 1-3/16 | 3 | 1-3/16" | N/A | N/A | N/A |
| R-B-3000092 | 9218, Door | 2 | N/A | N/A | N/A | N/A |
| R-B-6060014 | 1-15 HP Motor Platform | 1 | N/A | N/A | N/A | N/A |
| R-B-7010025 | Parts Bag, Separate, 1-15HP Motor Platform | 1 | N/A | N/A | N/A | N/A |

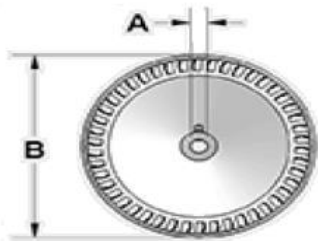

Wheel

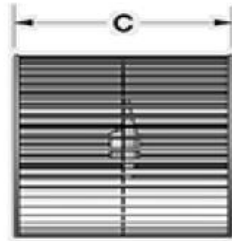

Bearing, Bearing Bracket and Shaft

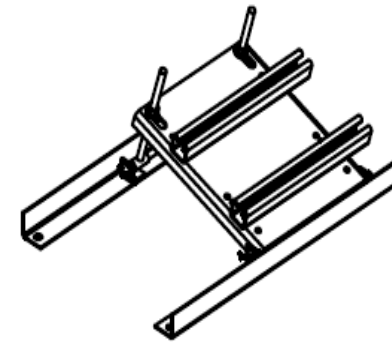
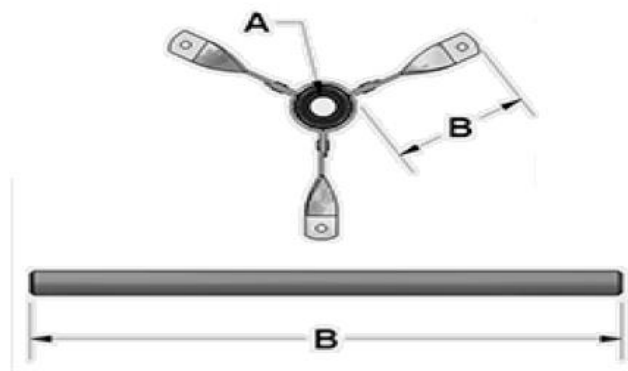

Motor Mount Platform

9220-2 Duct Blower - Part# 9020044

| Part Number | Description | Qty Required | Dimensions | | | |
|-------------|---|--------------|------------|---------|---------|-------|
| | | | A | B | C | D |
| R-6030087 | Wheel, 920-18BD-54-2-3/16-RH-RCD-LH-LCD | 2 | 2-1/4" | 20-3/4" | 20-3/8" | N/A |
| R-2100101 | Shaft, 2-3/16 X 85-5/8, 4KWY | 1 | 2-3/16" | 85-5/8" | N/A | 4 Kwy |
| R-B-8100038 | Cast Iron Pillow Block Bearing, 2-1/4 (NTN) | 2 | 2-3/16" | N/A | N/A | N/A |
| R-B-3000100 | 9220, Door | 2 | N/A | N/A | N/A | N/A |

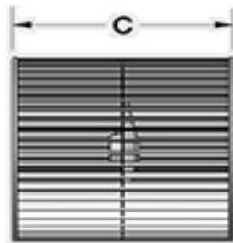
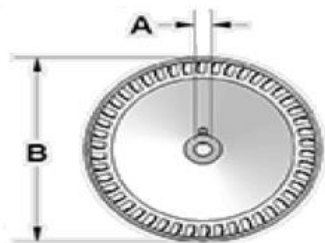

Wheel

Bearing, Bearing Bracket and Shaft