

Scentinel Series

Scentinel 1 - Single Carbon Filter Blower



(For use with DFRC-6ES model ONLY)

OPERATION INSTRUCTIONS AND PARTS MANUAL *READ AND SAVE THESE INSTRUCTIONS*

The purpose of this document is to aid in the proper assembly & installation for the Canarm Single Carbon filter blower "Scentinel 1". Please note that is for the DFRC-6ES models only. These instructions are intended to supplement the assembly instructions of the DFRC-ES provided in your assembly kit. They are good general practices and are not intended to overwrite local codes and ordinances.

IT IS THE RESPONSIBILITY OF THE PURCHASER TO ENSURE THAT THE MAINTENANCE OF THIS EQUIPMENT IS HANDLED BY QUALIFIED PERSONNEL.

GENERAL SAFETY

1. Read this document, the installation manual of the DFRC-ES and decide how to install the kit in your specific location.
2. Locate and ensure all required assembly parts are prepared in advance of beginning work.
3. Always work with best safety practices in mind. Wear safety glasses, gloves and keep a clean working environment etc.
4. As noted in the DFRC-ES manual, the blower contains spinning parts, so install the assembly high enough to avoid contact with pets.
5. Be aware that the carbon filter is heavy enough to present a falling hazard. Ensure that it is secured properly.
6. If you choose to make changes to the provided kit, do so in accordance with local codes and best safety practices.
7. Please follow all applicable national, state/provincial and local codes, of them will supersede this manual.

ASSEMBLY INSTRUCTIONS

1. Clean and clear the work site, and ensure there are no tripping hazards or foreign debris that may interfere with the work ahead.
2. Carefully remove the parts from their boxes and inspect them for any damage that may have occurred during shipping.
3. Remove the plastic film around the carbon filter. Once the filter is exposed to the air, it will begin to activate. Cover the canister with the provided fabric sleeve.
4. Measure the components, take notes and plan for the finished installation in advance.
5. Install the DFRC-6ES first, in a location that enables the proper and safe installation of the Electrical service, Carbon Canister & any duct work required.
6. **Note:** In the DFRC-ES manual, it recommends hanging the blower vertically. Be aware this may cause the carbon canister to slip and fall. The canister bracket may be modified to support the canister in this orientation. **(See Figure 1).**
7. Once the blower is installed and secure, attach the gasketed clamp provided by slipping it over the discharge end of the blower and tightening down the bolt on the blower side of the clamp. **(See Figure 2).**
8. Make sure the carbon canister support bracket is centered to the discharge of the blower or otherwise aligned with your installation plan. Fasten it to the wall or ceiling with the construction screws provided. **(See Figure 3).**
9. Slip the canister into position within the gasketed clamp and the canister support bracket. The "3 pin" side of the canister must be against the blower's discharge side. **(See Figure 4).**
Note: There are many possible configurations for your particular installation. Ensure the blower and canister are properly supported regardless of how or where it's installed.
11. Once the filter canister is in place and properly supported, tighten the gasketed clamps bolt to lock it into place.
12. Now that the blower and the canister are installed and secure, follow the instructions in the DFRC-ES manual to connect it electrically.
13. The canister will need to be replaced over time and use. To do this, simply release it from its gasketed clamp and any other fasteners used to secure it. Pop it out and replace it.

WARRANTY

CANARM Ltd. warrants every new product to be free of defects in material and workmanship, to the extent that, within a period of one year from the date of purchase CANARM Ltd. shall either repair or replace at CANARM's option, any unit or part thereof, returned freight prepaid, and found to be defective.

This warranty does not include any labour or transportation costs incidental to the removal and reinstallation of the unit at the user's premises. Components repaired or replaced are warranted through the remainder of the original warranty period only.

This warranty applies to the original purchaser-user only; it is null and void in case of alteration, accident, abuse, neglect, and operation not in accordance with instructions.

NOTICE: No warranty claims will be honored by CANARM Ltd. unless prior authorization is obtained.

**Installation or Product problems? Do not return to store of purchase.
Contact Canarm Service at 1-800-265-1833 (CANADA) 1-800-267-4427 (U.S.A.)
1-800-567-2513 (EN FRANCAIS) Monday to Friday 8:00 - 5:00pm e.s.t.**

Canarm Ltd. - Corporate Head Office 2157 Parkedale Avenue, PO Box 367 Brockville, Ontario Canada K6V 5V6
Tel: (613) 342-5424; Fax: (613) 342-8437

www.canarm.com

hvacsales@canarm.ca

INSTALLATION

FIGURE 1: CANISTER AND POSSIBLE INSTALLATIONS

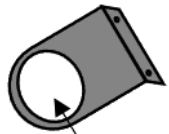

For your convenience, the canister support bracket may be used in several orientations.

Slip the canister through the hole, or use the flat section to support it (you may need to use zip ties or other securing hardware not provided).



For a horizontal install, slip canister through the support bracket.

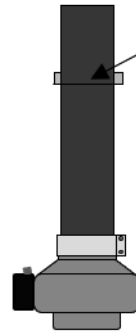

In the vertical position, the bracket may be used to keep the canister from tipping.

Or by shifting the bracket over, it can support the canister weight.

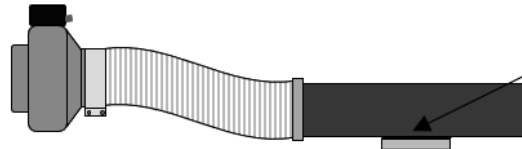
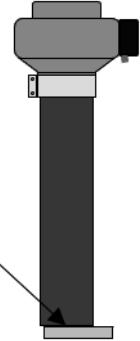

For a remote install, the support bracket may be used to brace the weight. A short section of the duct & hose clamp may be needed (not provided).

FIGURE 2: BLOWER DISCHARGE & GASKETED CLAMP

Intake side

The canister **MUST** be installed on the discharge side.

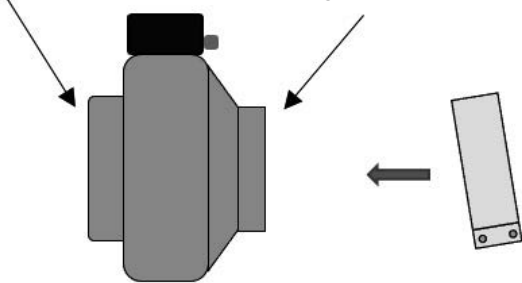

The gasketed clamp slips over the discharge side, and has two set screws - one for the blower and one for the filter or duct.

FIGURE 4: FILTER CANISTER INSTALL

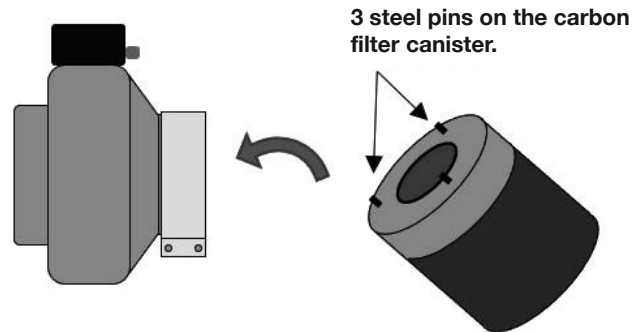

3 steel pins on the carbon filter canister.

Note: The side of the carbon filter canister with 3 pins, must always be installed in the discharge side of the blower. Tighten the clamps' bolt once installed for a tight seal.

FIGURE 3: ALIGNMENT & SECURING SUPPORT BRACKET

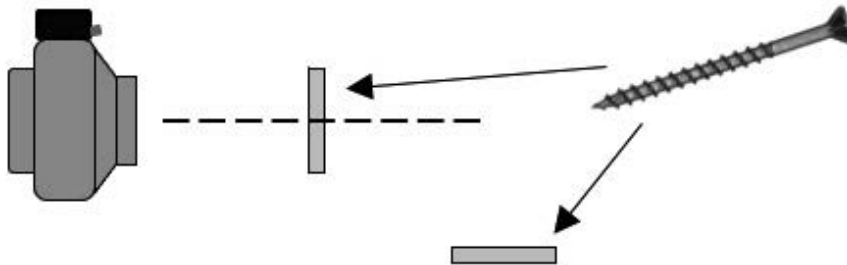

Whether the canister and bracket are being installed directly, remotely, vertically or horizontally, always plan the location and secure the support bracket in advance.