



COMFY
CALF Suites



CANARM LTD. - Corporate Office
PO Box 367 2157 Parkedale Ave.,
Brockville, ON
Canada K6V 5V6
Tel: (613) 342-5424 Fax: 1-800-263-4598

Arthur Manufacturing Facility
#7686 Concession 16, RR 4
Arthur, ON
Canada N0G 1A0
Tel: (519) 848-3910 Fax: (519) 848-3948

Montréal Warehouse
2555 Rue Bernard Lefebvre
Laval, PC
Canada H7C 0A5
Tel: (450) 655-2535 Fax: (450) 665-0910

CANARM LTD. - USA Warehouse
808 Commerce Park Drive
Ogdensburg, New York,
USA 13669
Tel: 1-800-267-4427 Fax: 1-800-263-4598

www.canarm.com
Subject to Change without notice.

agsales@canarm.ca
Printed in Canada

• TOTAL OF 59 CALF SUITES

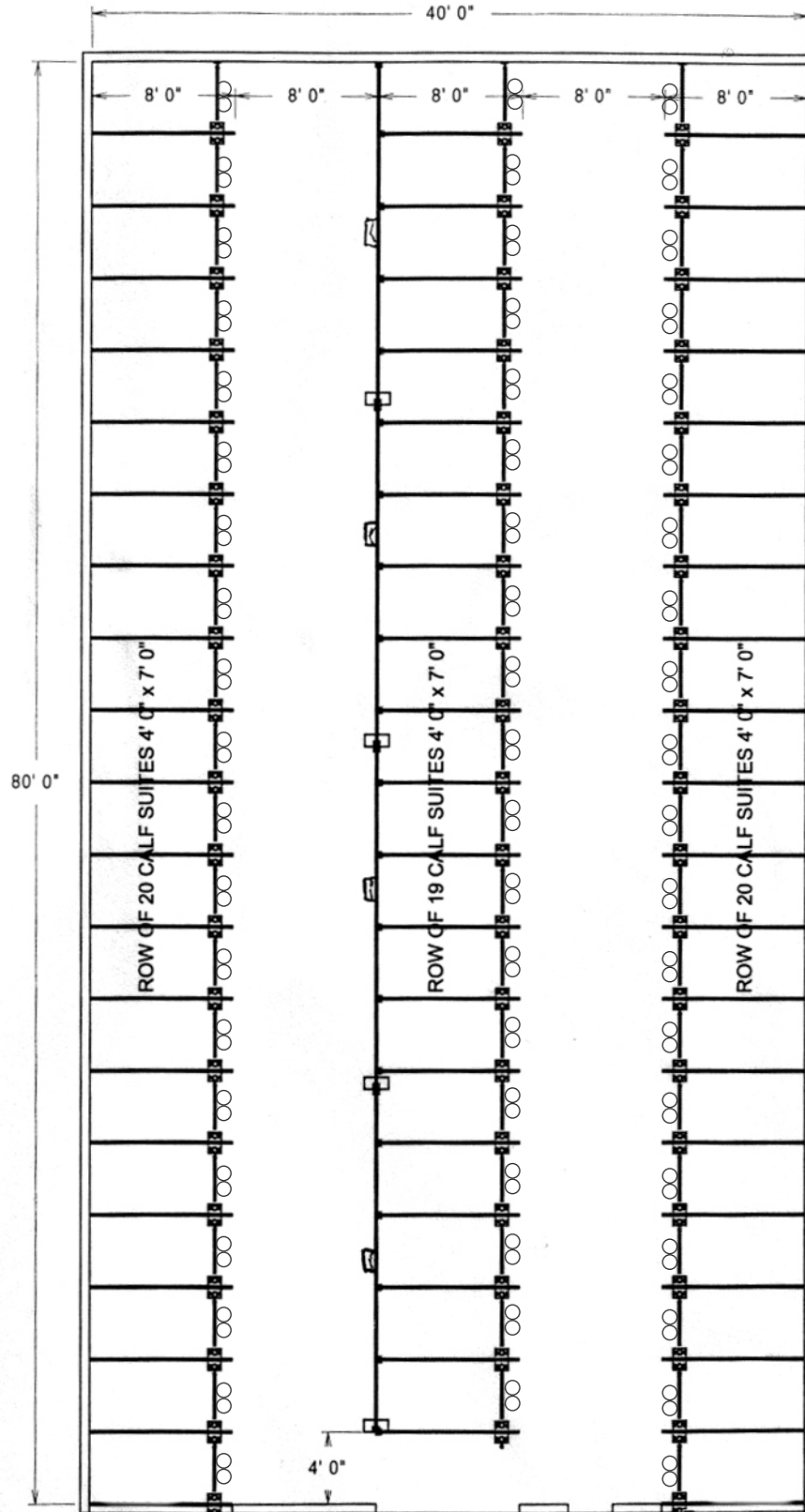

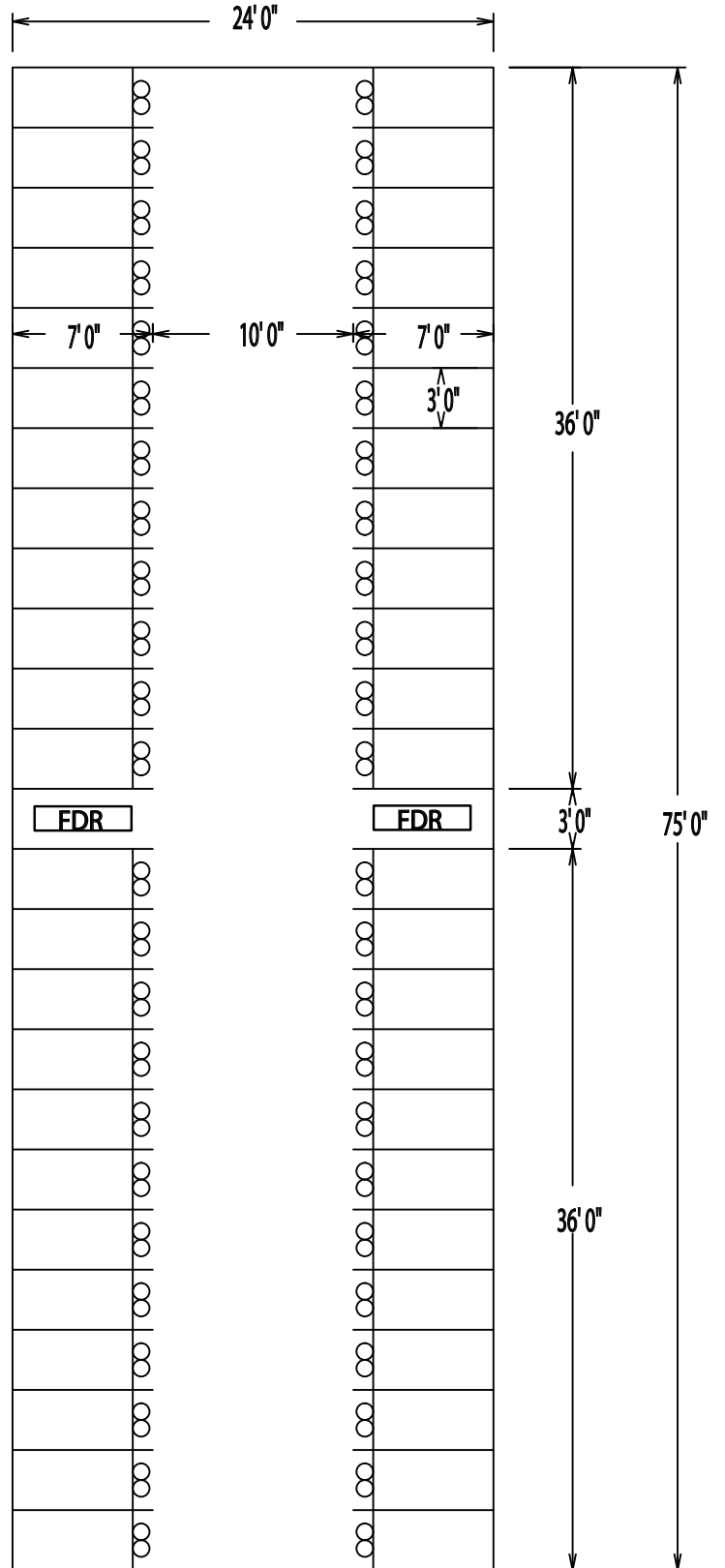
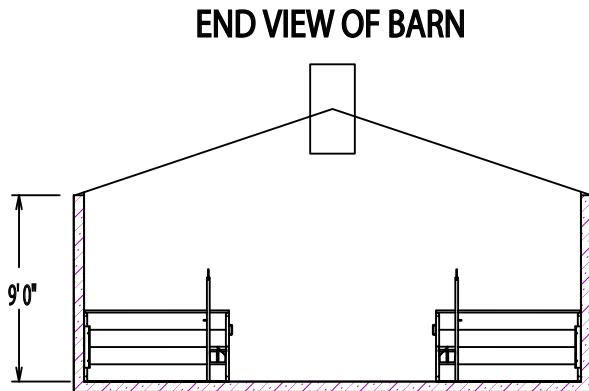

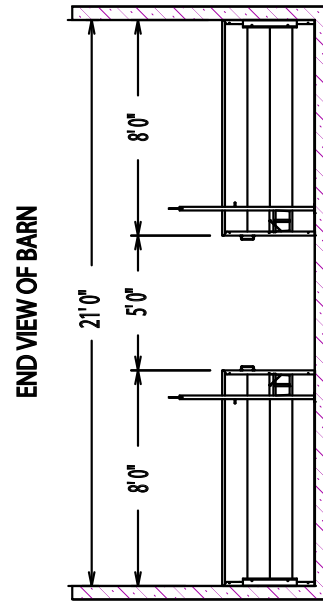
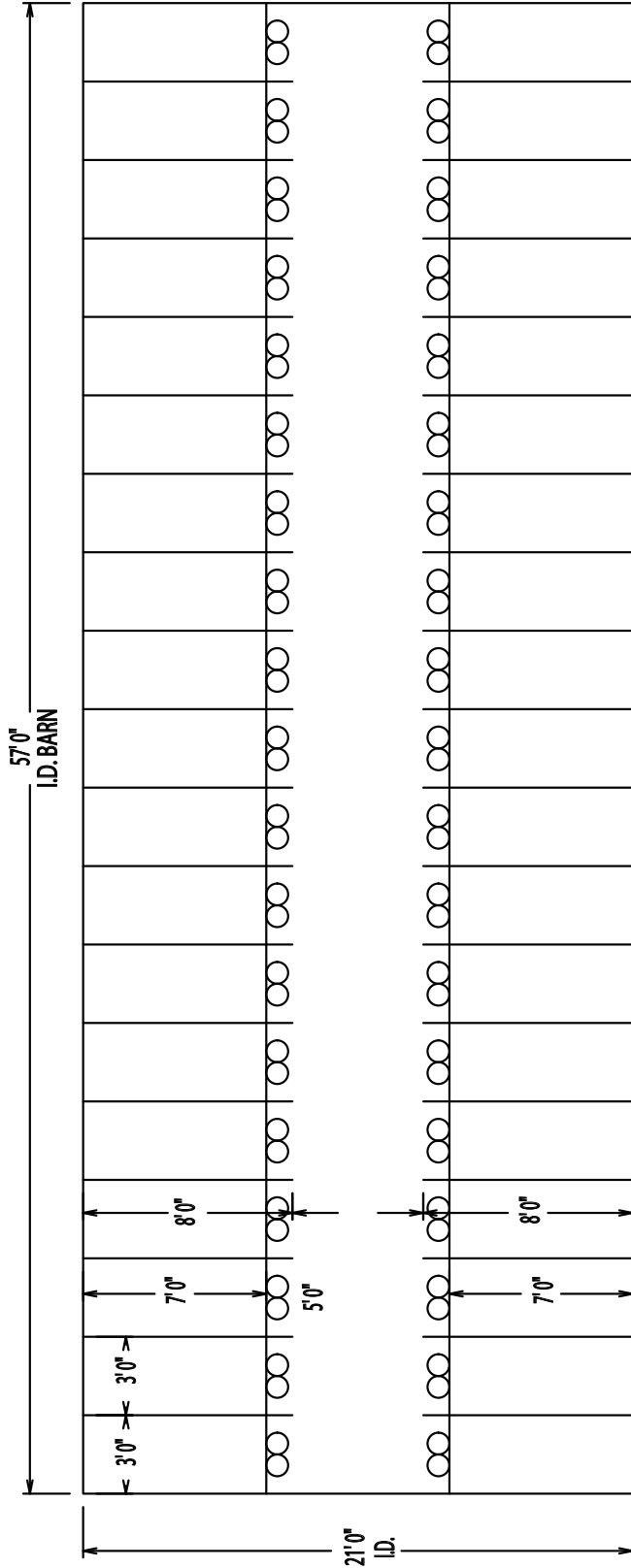

• 32 PENS TOTAL

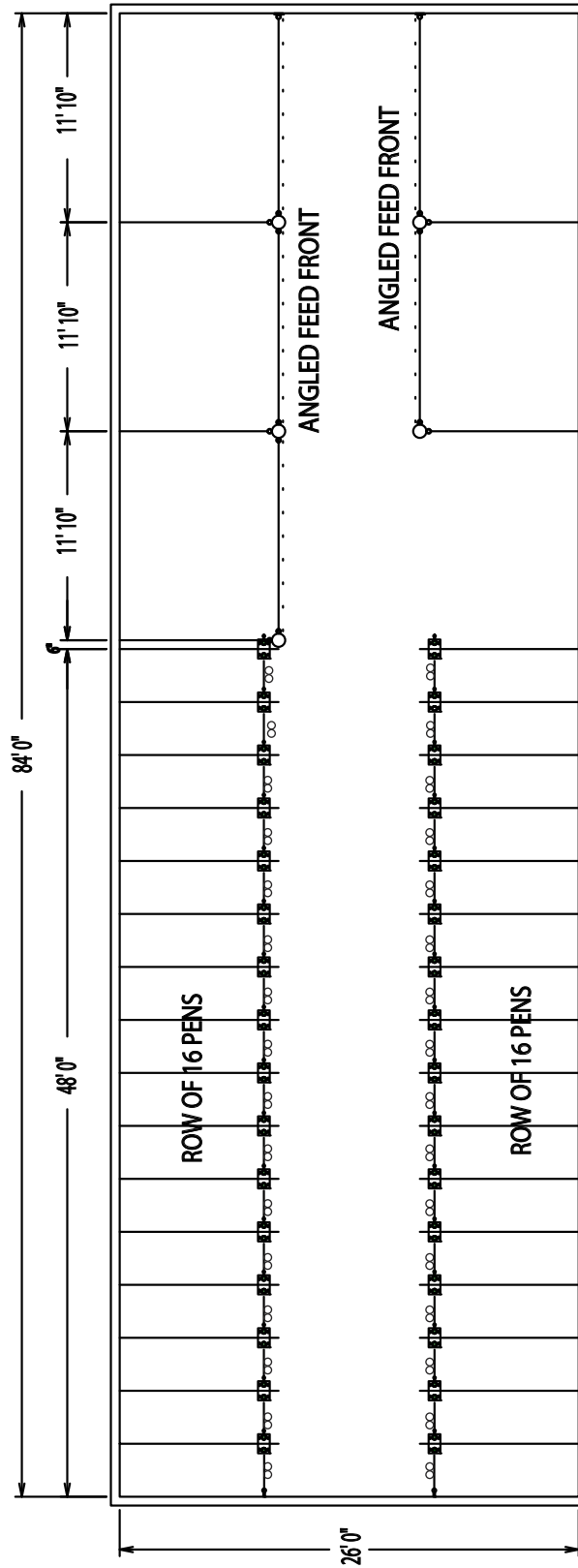

• 83 PENS TOTAL

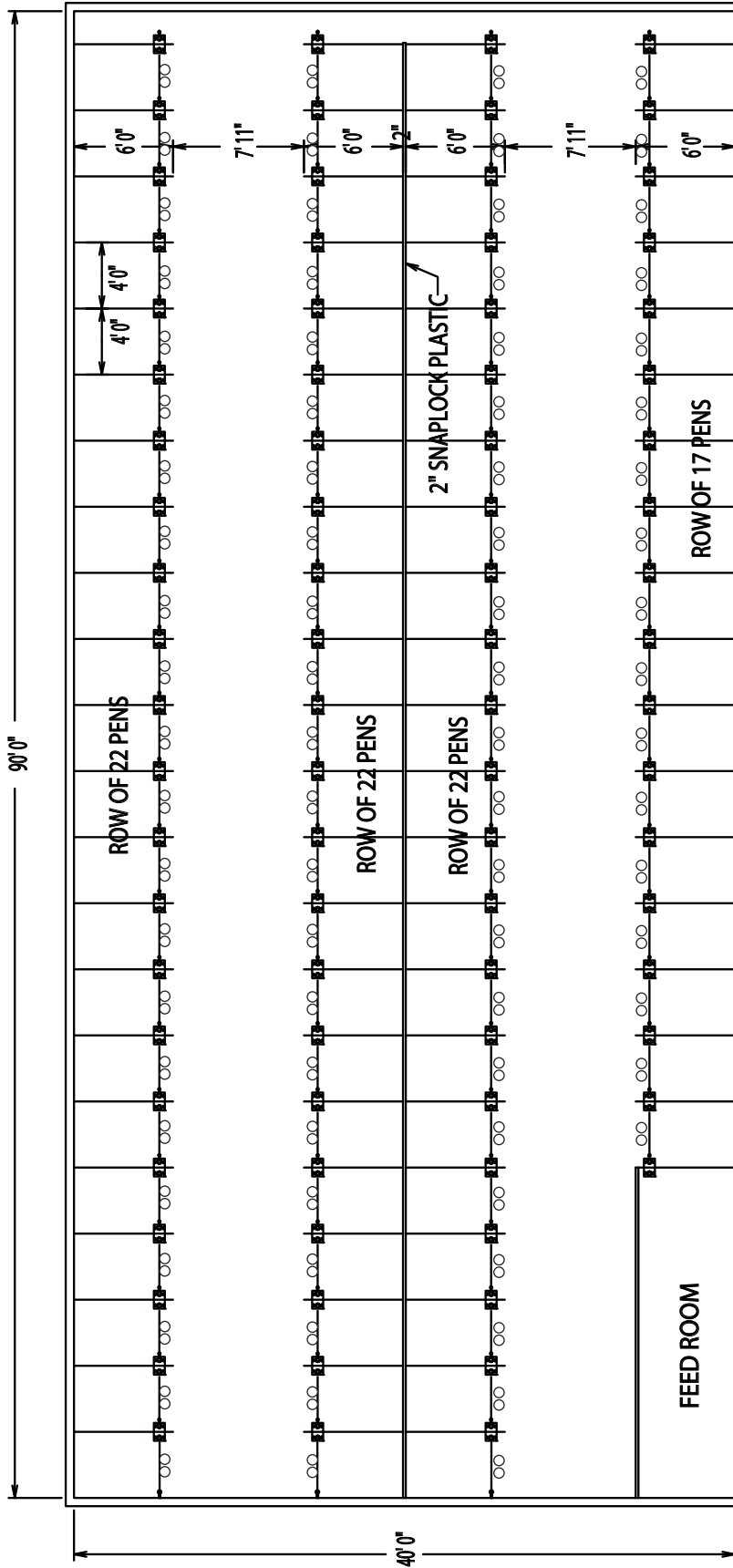

• 60 PENS TOTAL

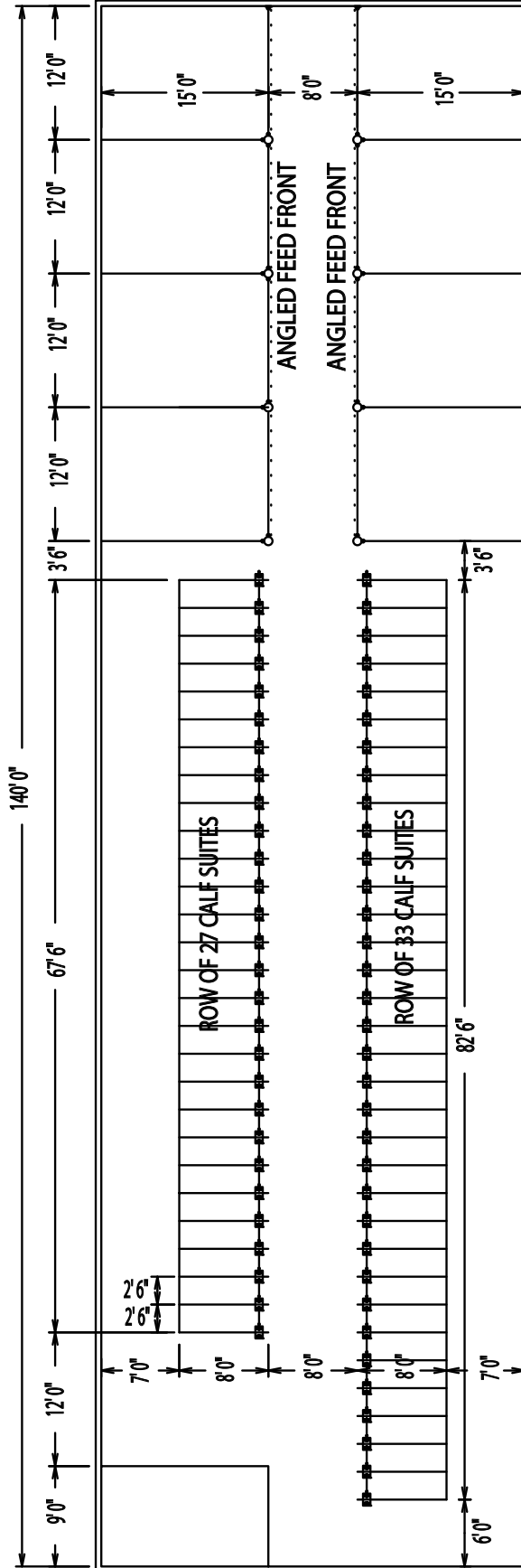

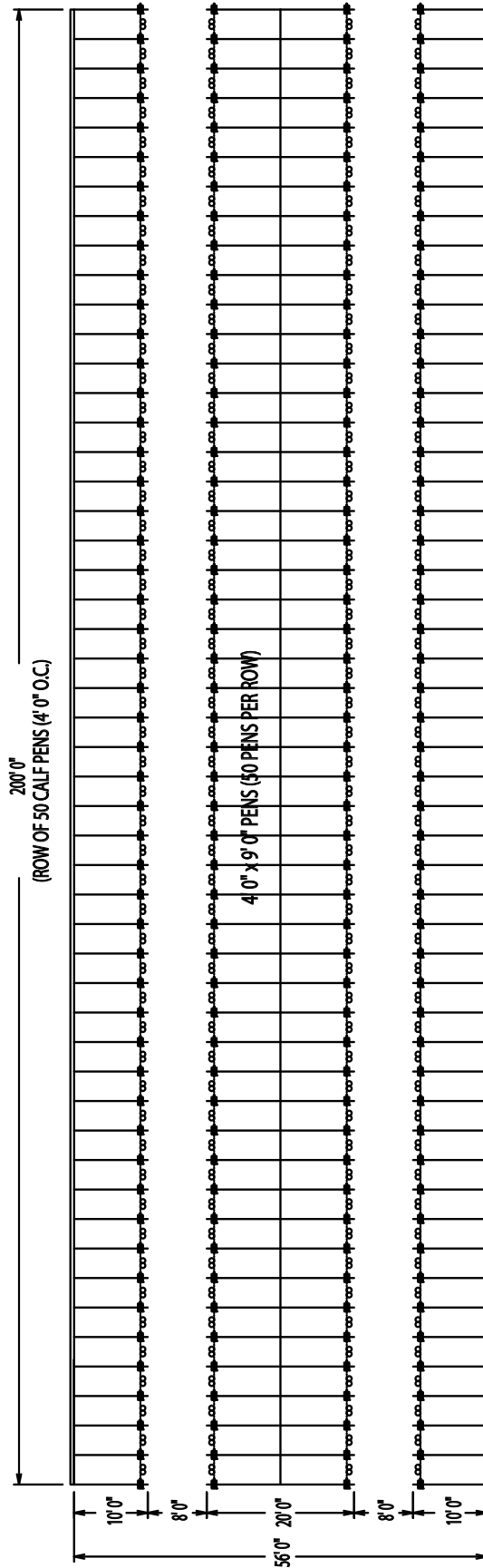

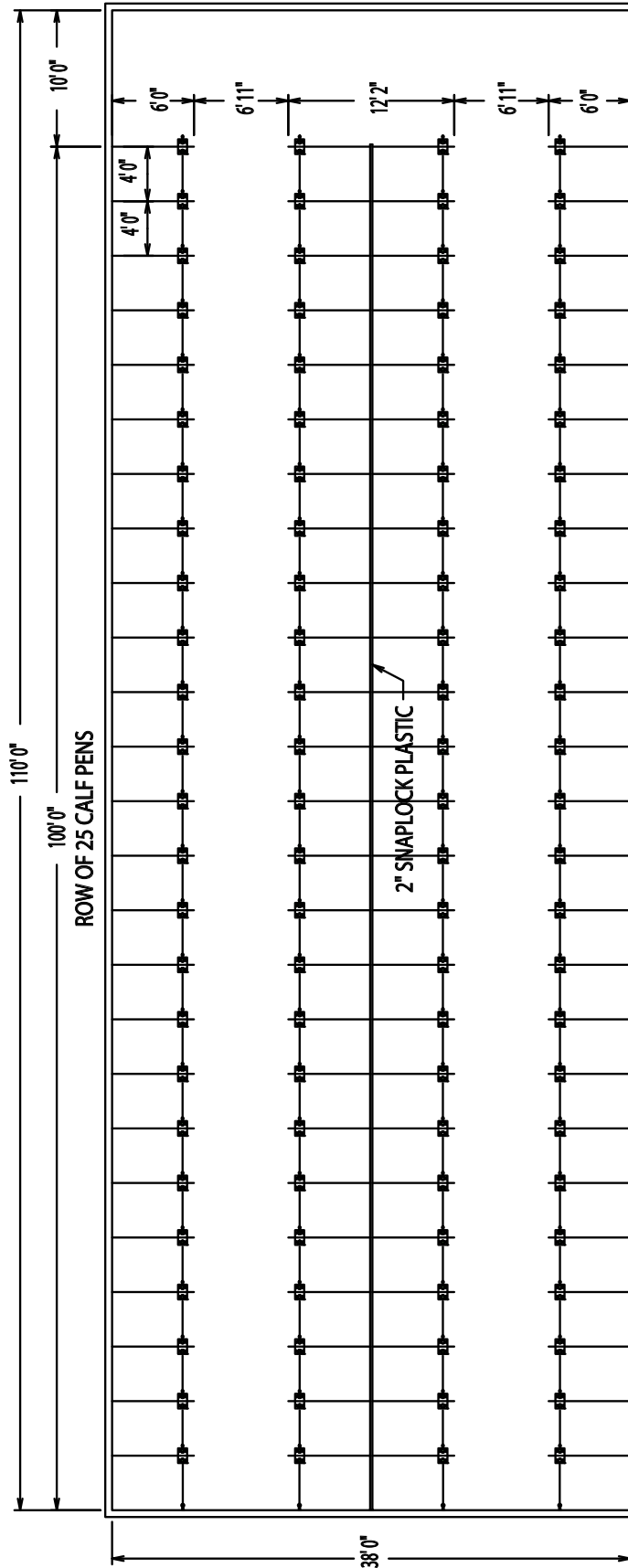



CANARM LTD. - Corporate Office
PO Box 367 2157 Parkedale Ave.,
Brockville, ON
Canada K6V 5V6
Tel: (613) 342-5424 Fax: 1-800-263-4598

Arthur Manufacturing Facility
#7686 Concession 16, RR 4
Arthur, ON
Canada N0G 1A0
Tel: (519) 848-3910 Fax: (519) 848-3948

Montréal Warehouse
2555 Rue Bernard Lefebvre
Laval, QC
Canada H7C 0A5
Tel: (450) 655-2535 Fax: (450) 665-0910

CANARM LTD. - USA Warehouse
808 Commerce Park Drive
Ogdensburg, New York,
USA 13669
Tel: 1-800-267-4427 Fax: 1-800-263-4598

- 4 PACK AREAS
- GATES
- FEED FRONTS

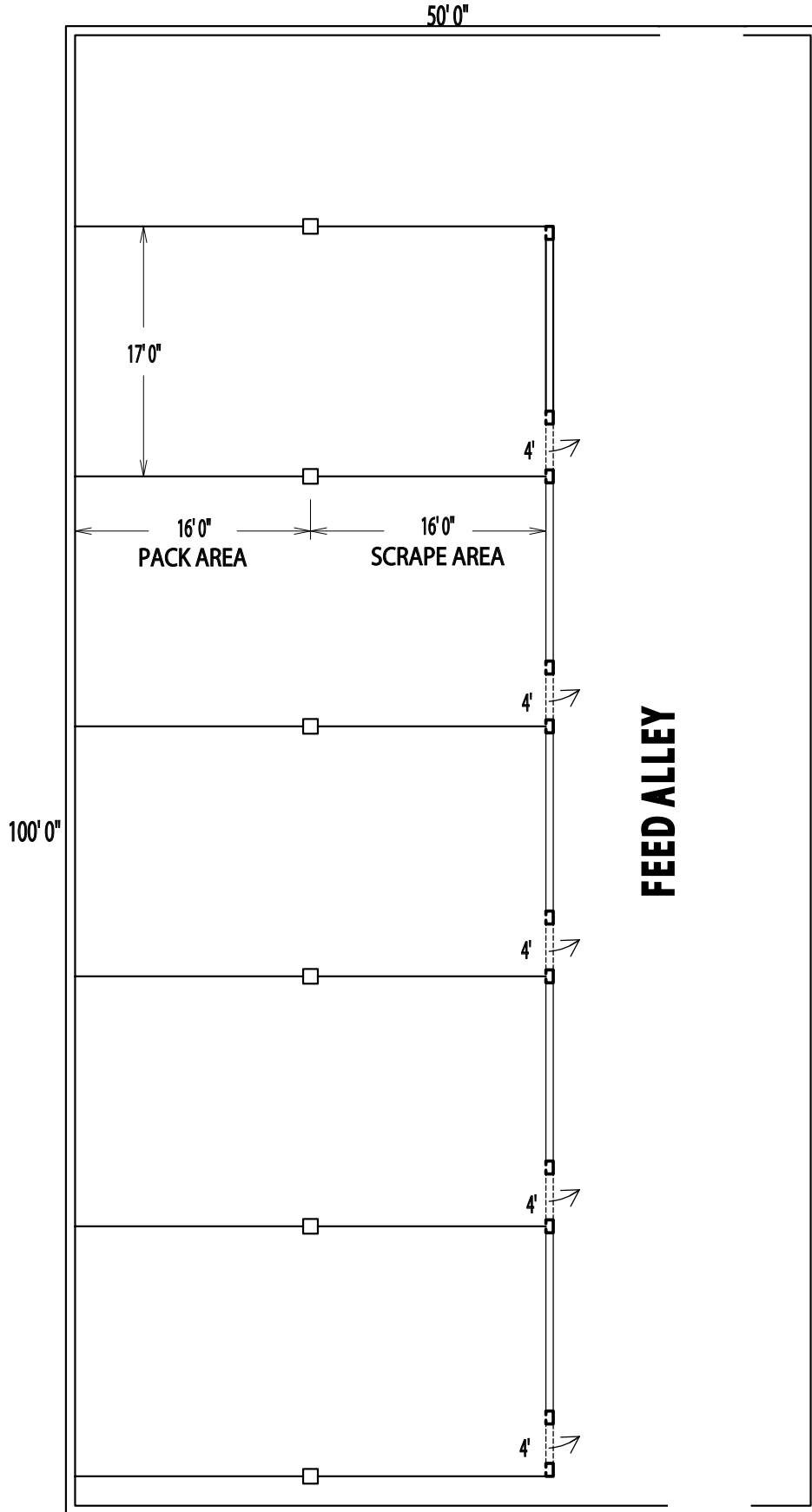

- 5-BAR GATES
- SELF LOCKING FEED FRONTS

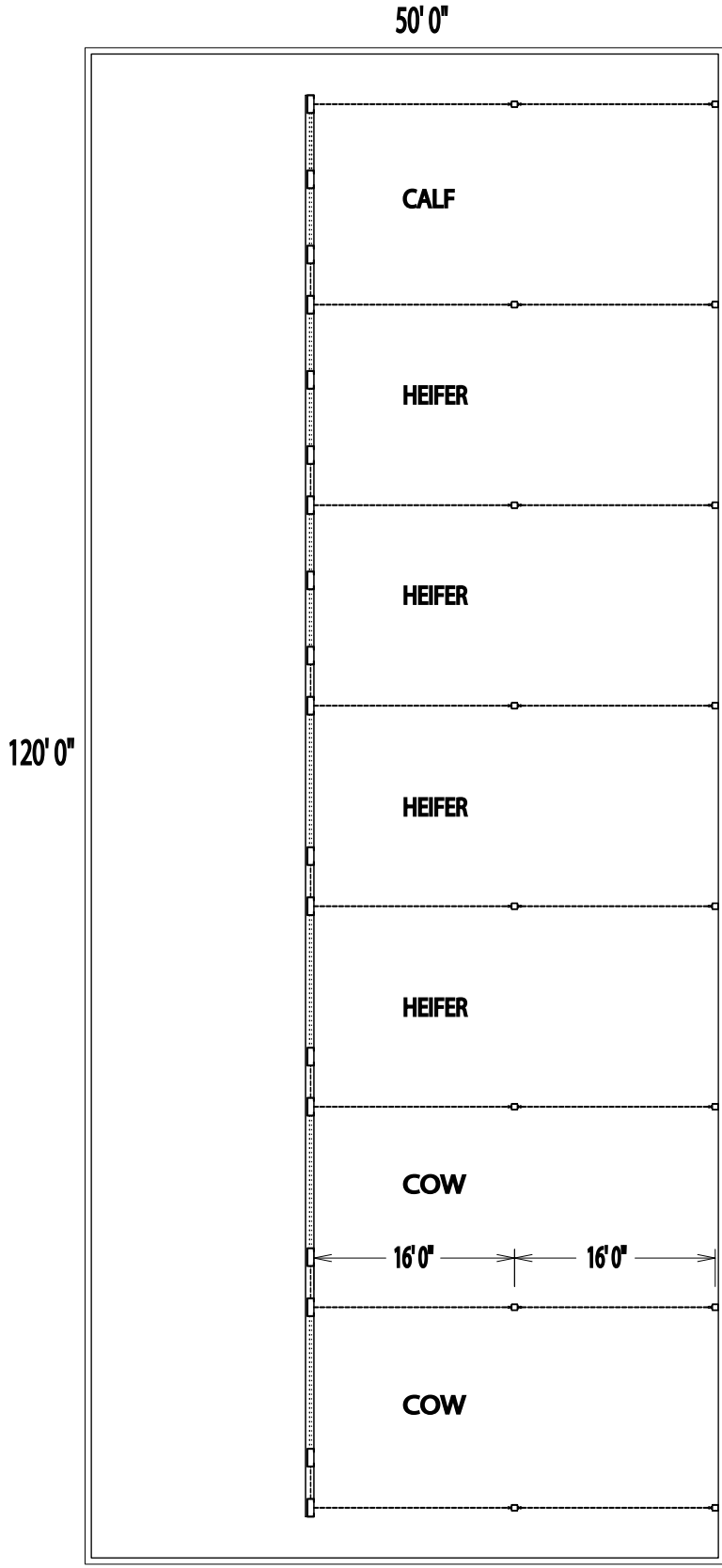

COW, HEIFER, CALF BARN

- SELF LOCKING FEED FRONTS
- GATES
- COMFY CALF SUITES

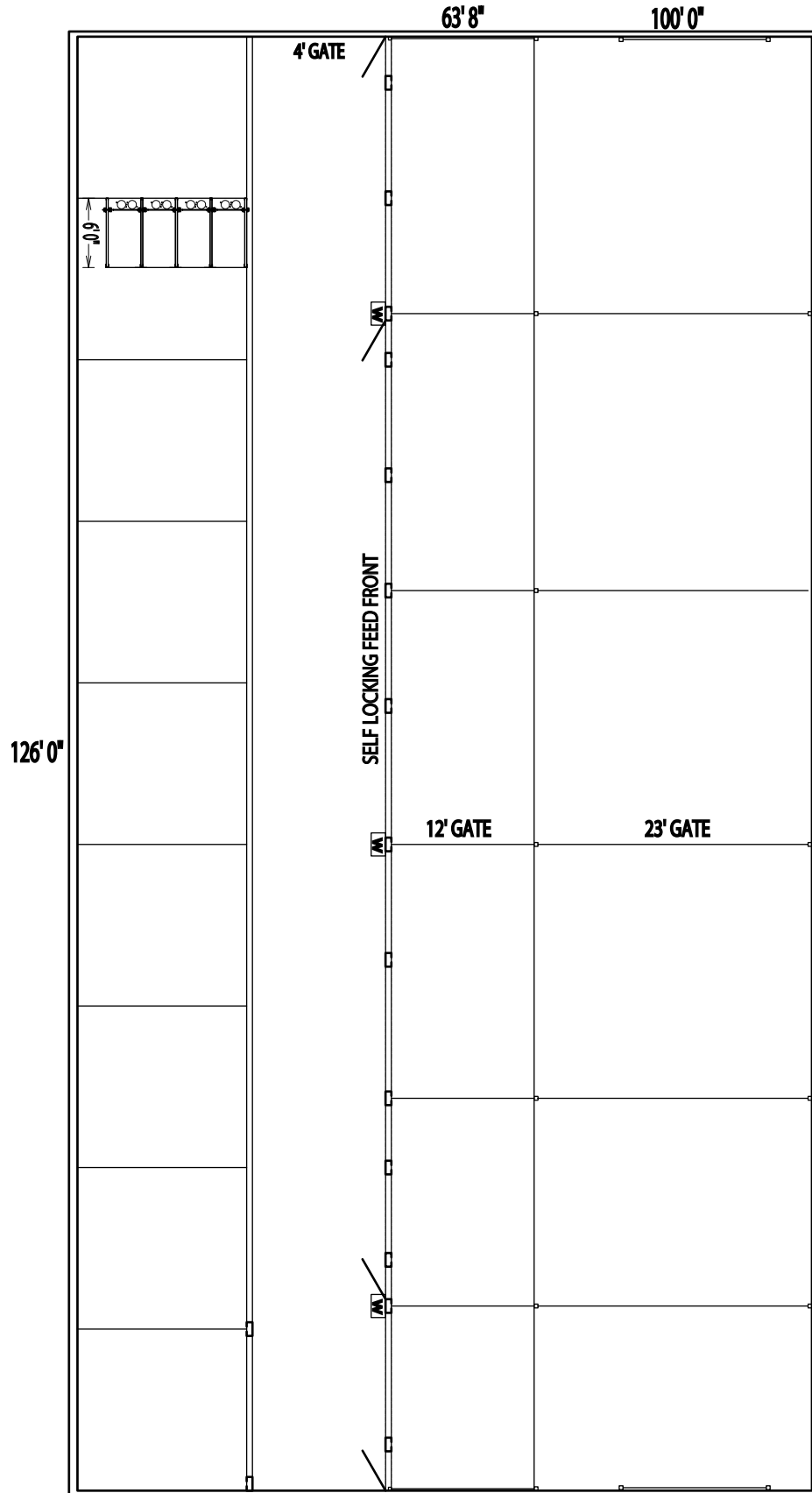



CANARM LTD. - Corporate Office
PO Box 367 2157 Parkedale Ave.,
Brockville, ON
Canada K6V 5V6
Tel: (613) 342-5424 Fax: 1-800-263-4598

Arthur Manufacturing Facility
#7686 Concession 16, RR 4
Arthur, ON
Canada N0G 1A0
Tel: (519) 848-3910 Fax: (519) 848-3948

Montréal Warehouse
2555 Rue Bernard Lefebvre
Laval, PC
Canada H7C 0A5
Tel: (450) 655-2535 Fax: (450) 665-0910

CANARM LTD. - USA Warehouse
808 Commerce Park Drive
Ogdensburg, New York,
USA 13669
Tel: 1-800-267-4427 Fax: 1-800-263-4598

www.canarm.com
Subject to Change without notice.

agsales@canarm.ca
Printed in Canada

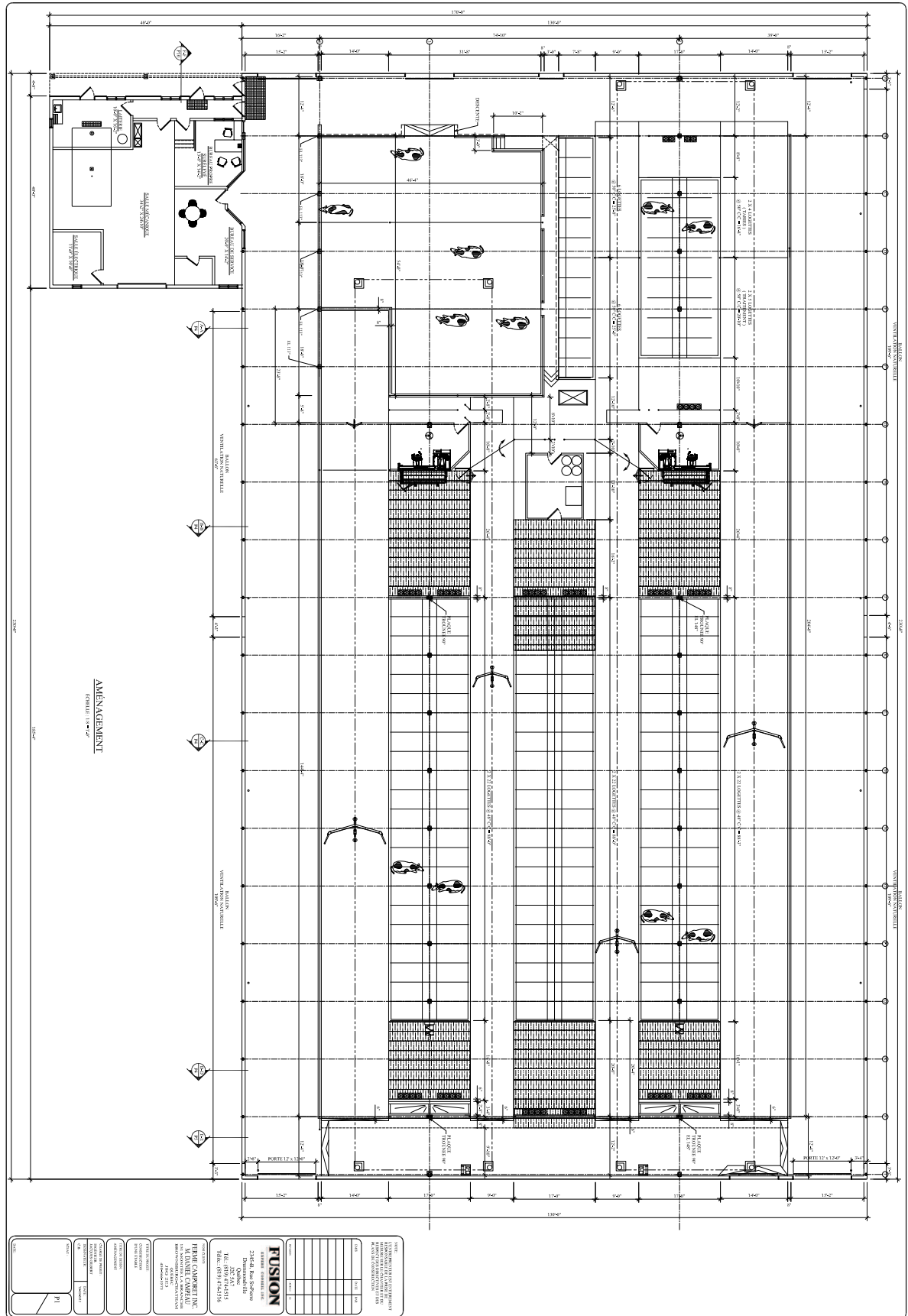

AMENAGEMENT
FORMULE 15-000-00

<p>FUSION 214248 Bunk System Système de couchage pour chevaux à 214248 Bunk System à 214248 Bunk System à 214248 Bunk System</p>		<p>CANARM INC. M. DANIEL CAMPBELL 1500, RUE SAINT-JACQUES SHERBROOKE, QUÉBEC J1R 3Y3 438-2222</p>	
<p>PROJET: _____ DATE: _____ DÉSIGNÉ PAR: _____ DÉSIGNÉ PAR: _____ DÉSIGNÉ PAR: _____</p>		<p>PROJET: _____ DATE: _____ DÉSIGNÉ PAR: _____ DÉSIGNÉ PAR: _____ DÉSIGNÉ PAR: _____</p>	

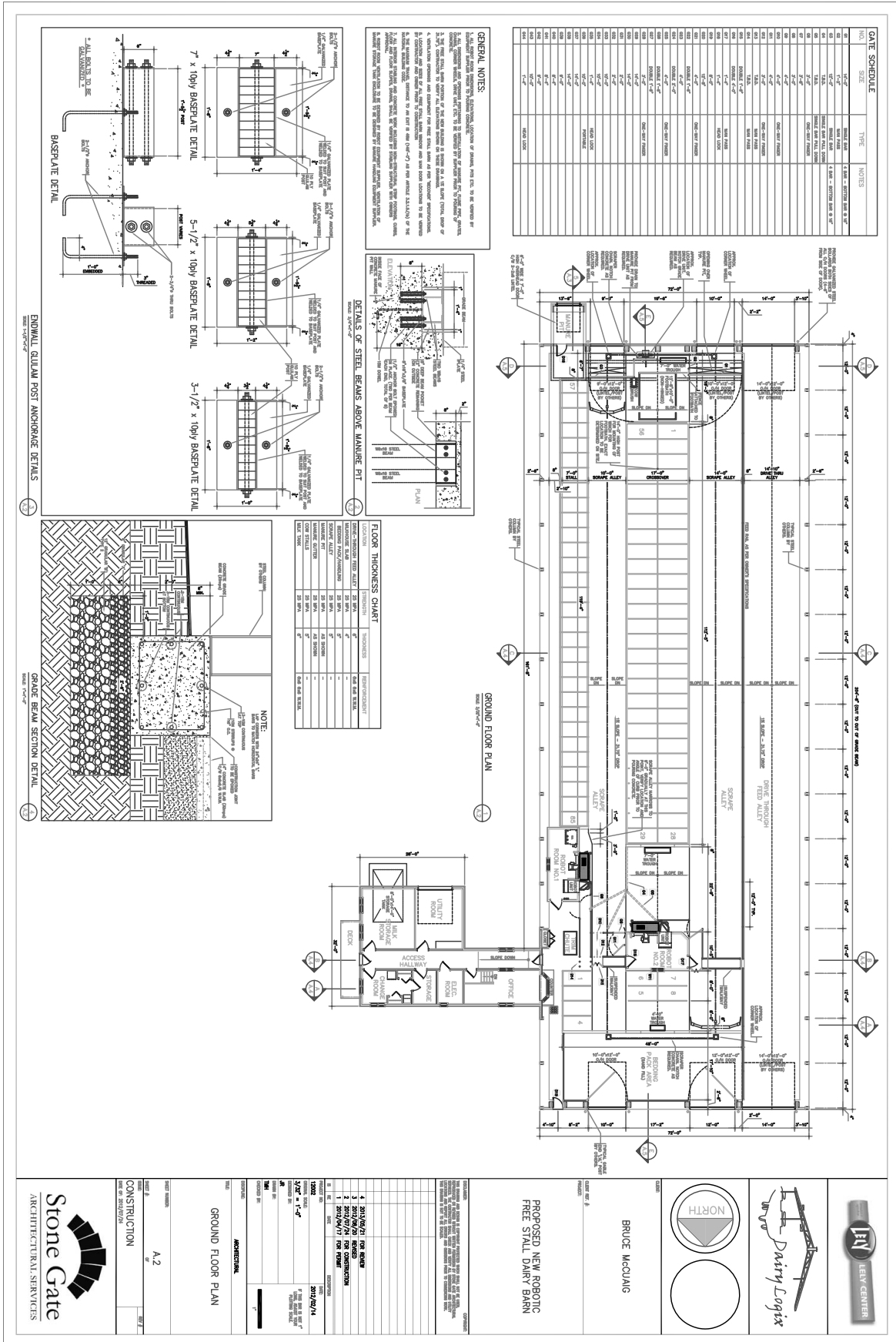

- ROBOT DAIRY BARN
- 1 ROBOT

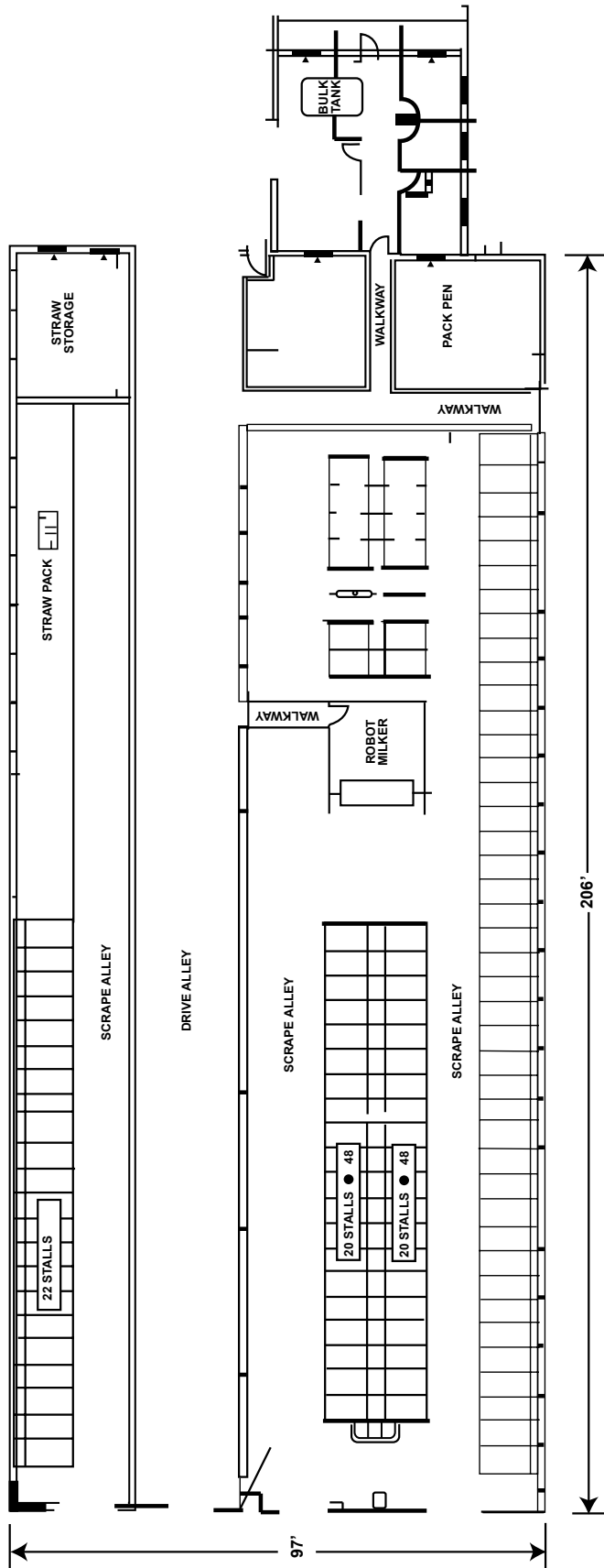

- ROBOT DAIRY BARN
- 2 ROBOTS

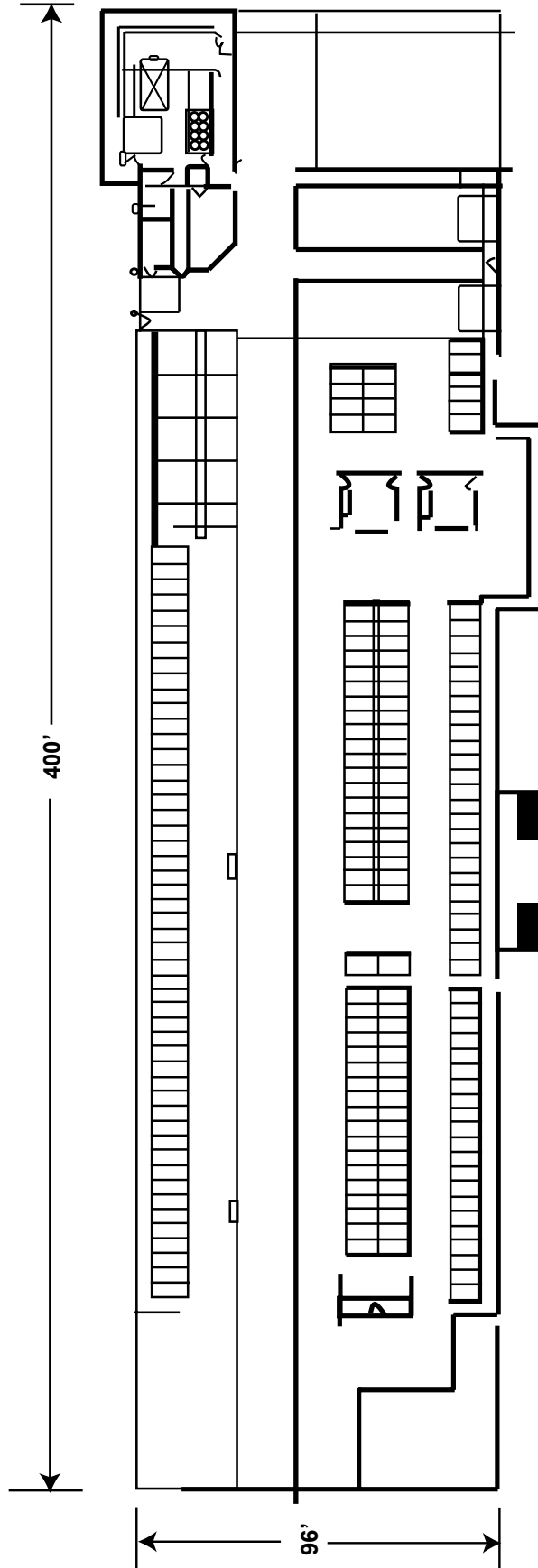

- 120 FREESTALLS
- TIP TROUGH
- SELF LOCKING FEED FRONTS

OFFICE & MILKHOUSE

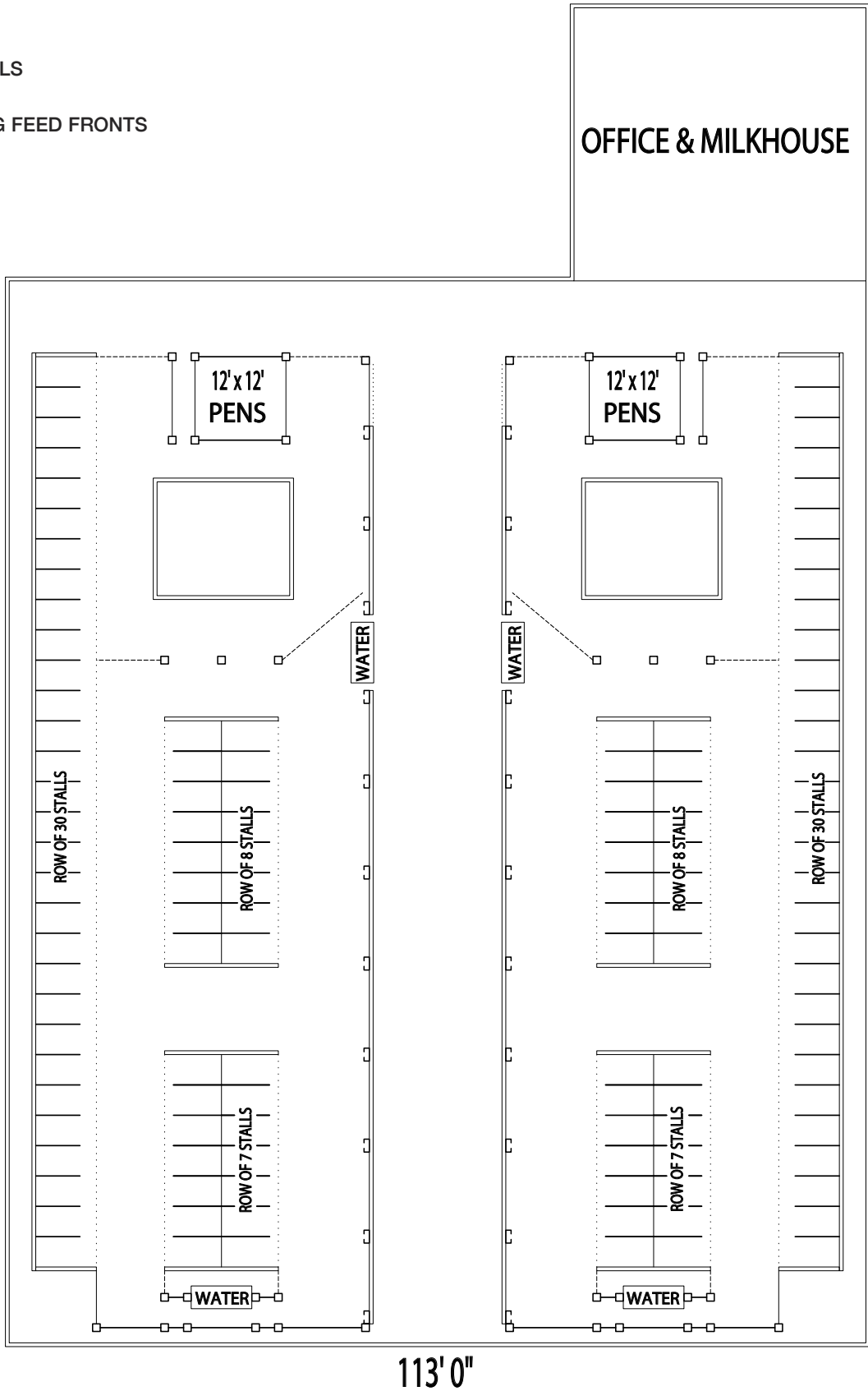

97' 4"

- 154 FREESTALLS
- 12 TIE STALLS

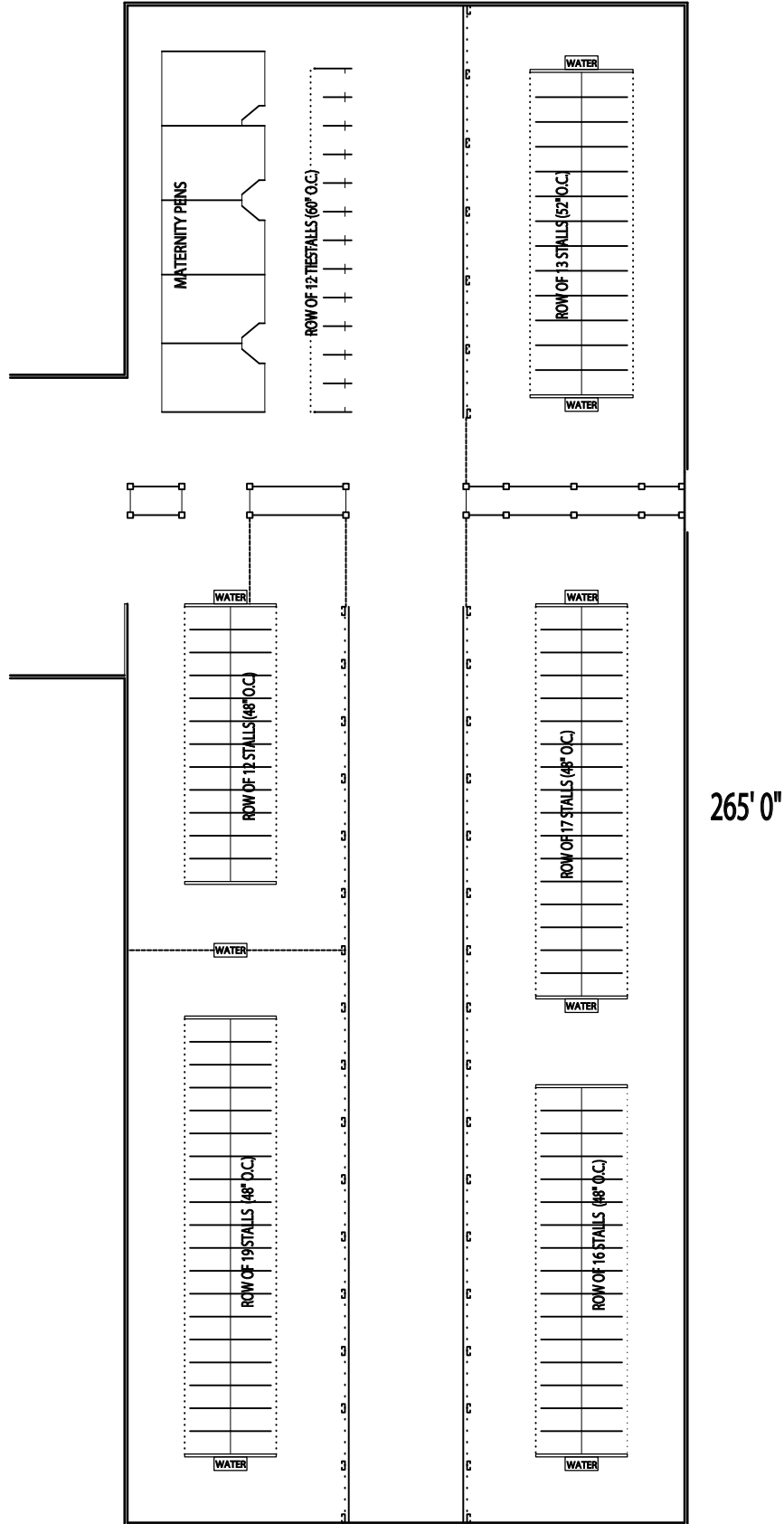

265' 0"

- COVERALL STRUCTURE
- 62 COW STALLS
- SAND BEDS
- SCRAPER SYSTEM

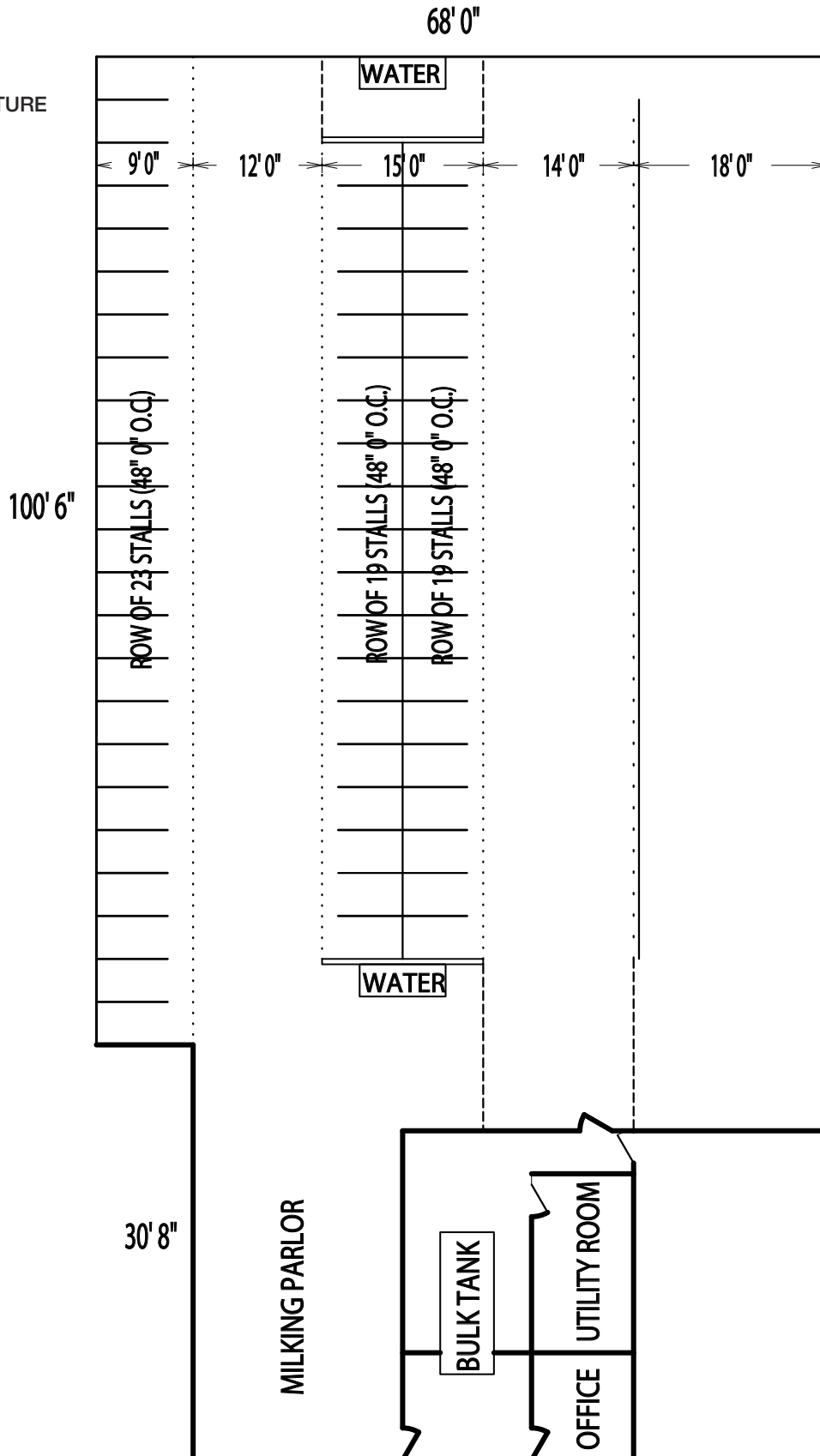

- 210 COW STALLS (FREESTALLS)
- GATES

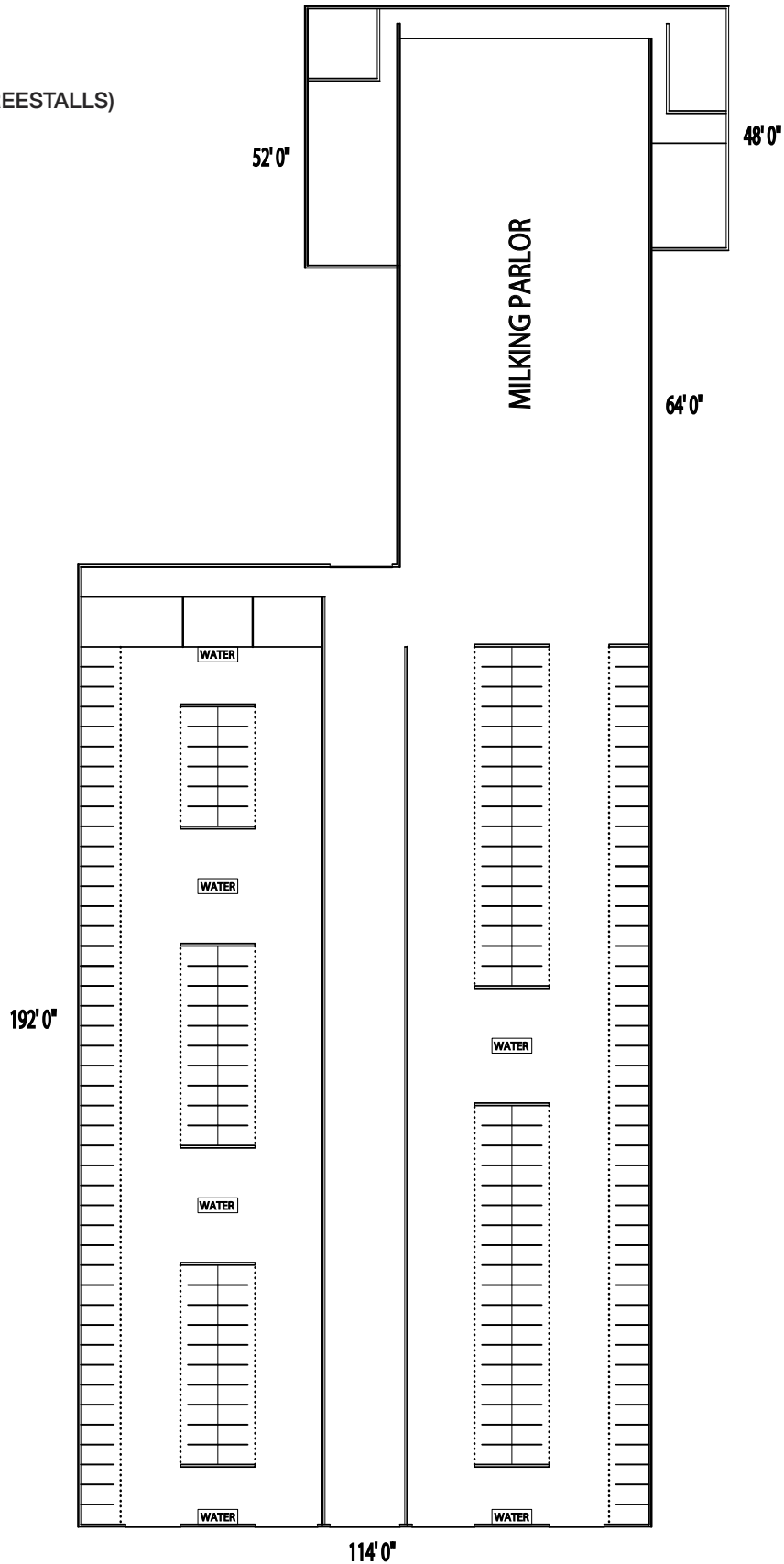

• FREESTALLS & GATES

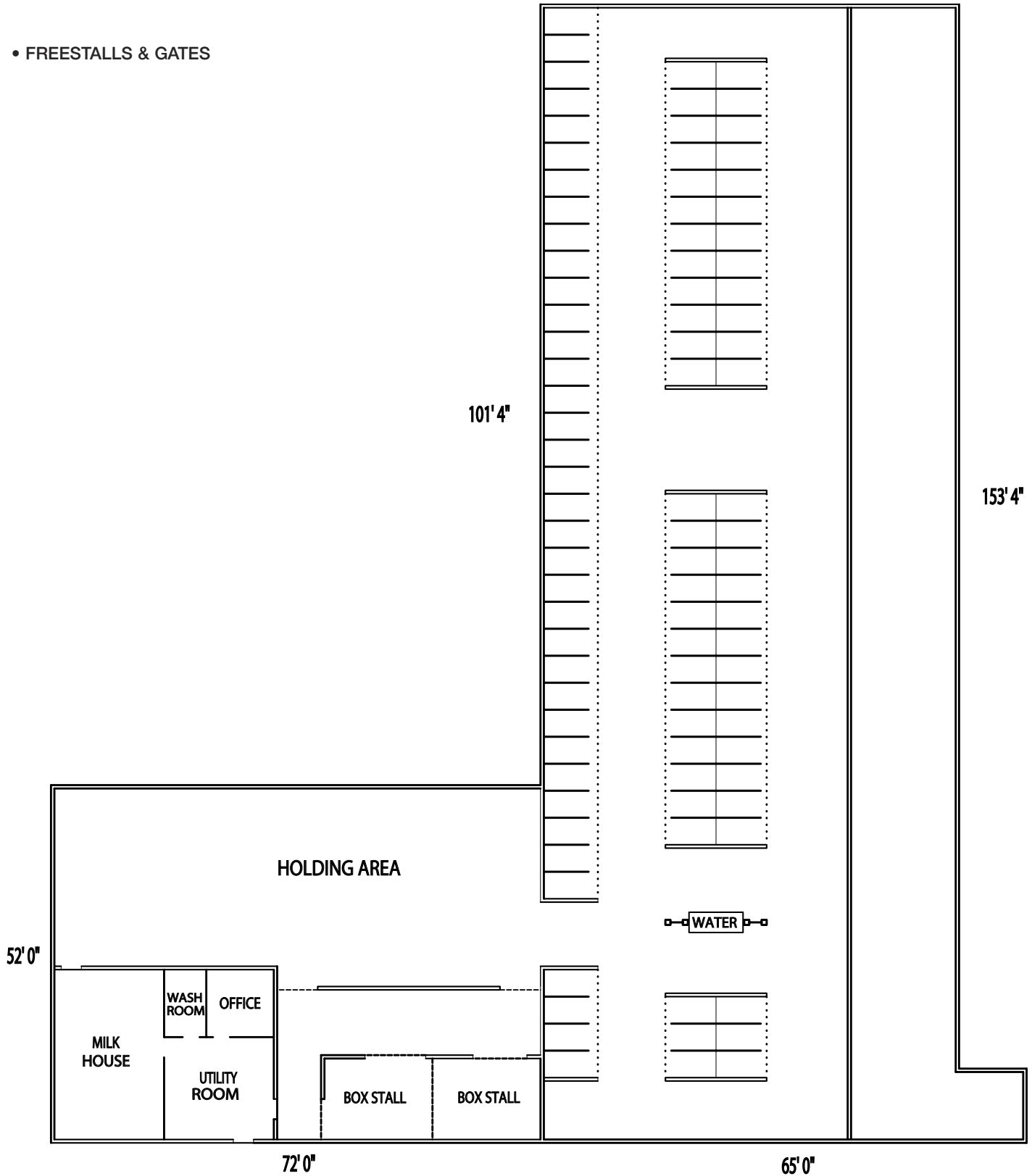

- 123 STALLS (SUSPENDED)
- LOCKOUT SELF LOCKING FEED FRONTS
- SCRAPE ALLEYS
- DOUBLE 8 PARLOUR

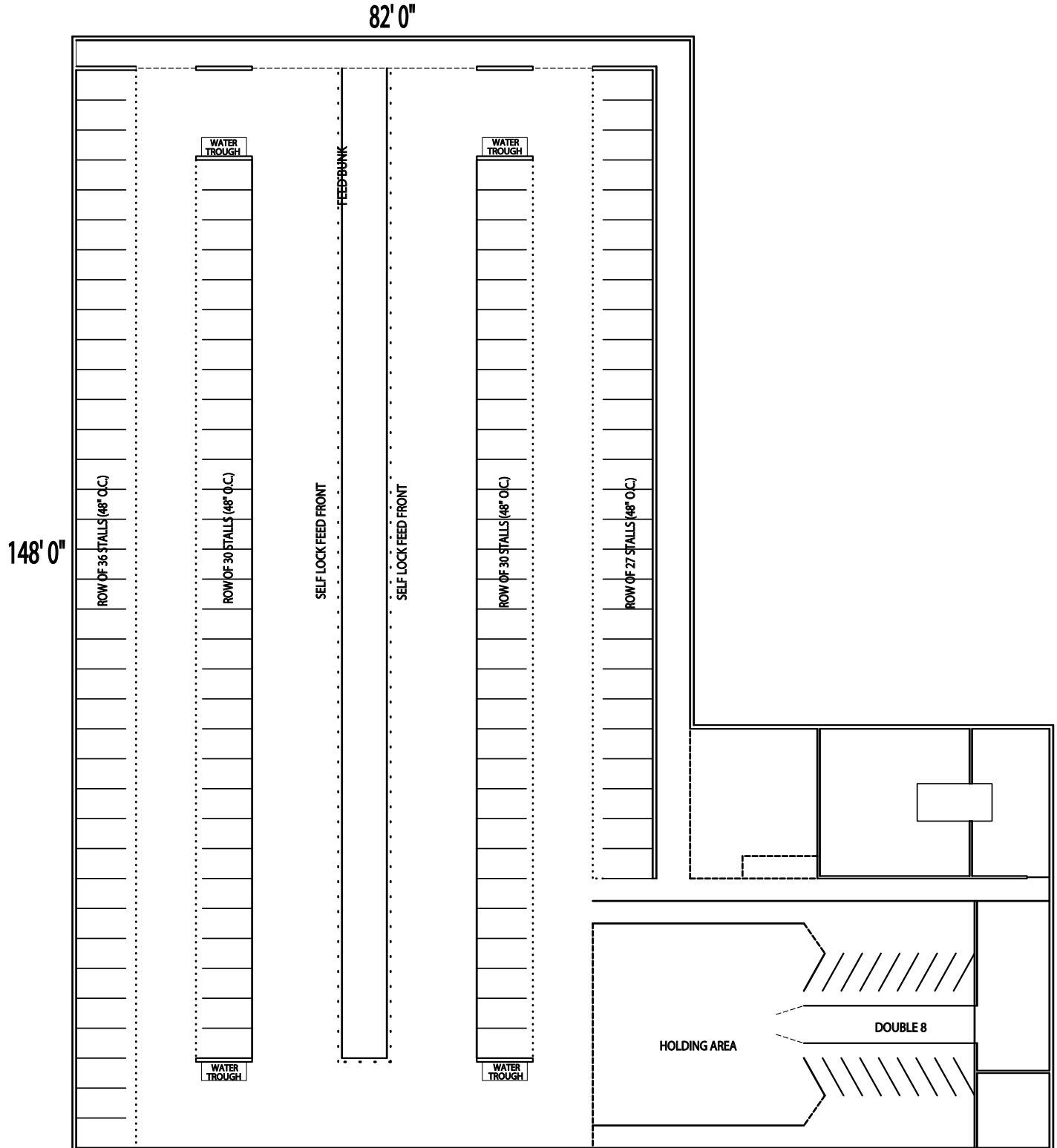

- 89 STALLS / COW
- 26 STALLS HEIFER / CALF
- 26 STALLS HEIFER / CALF
- SELF LOCK & PIPE RAIL
- ALLEY SCRAPERS (HYDRAULIC)
- TMR - FEED CART
- LOW CEILING (HOT BARN)

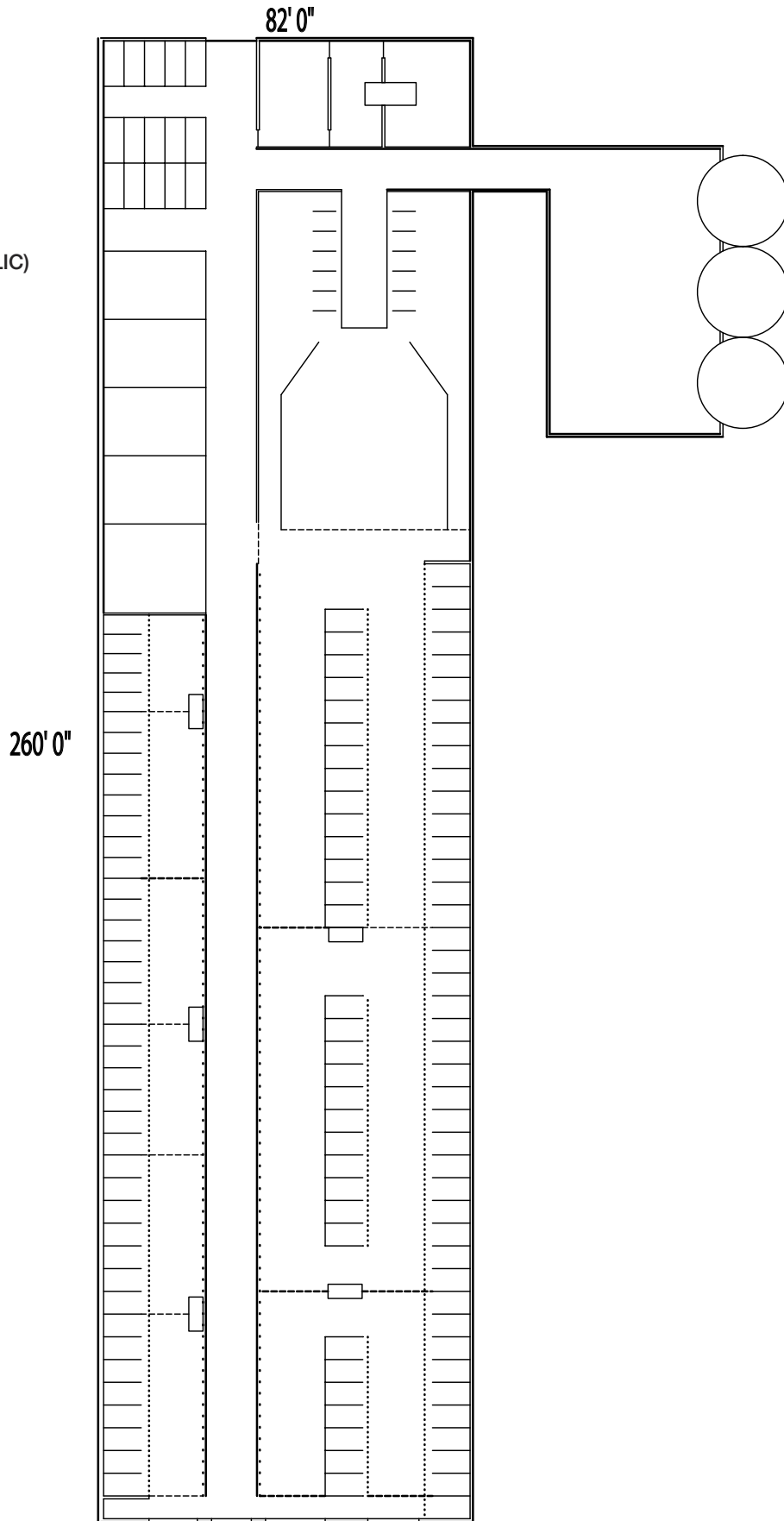

- 104 STALLS (SUSPENDED)
- LOCKOUT SELF LOCK

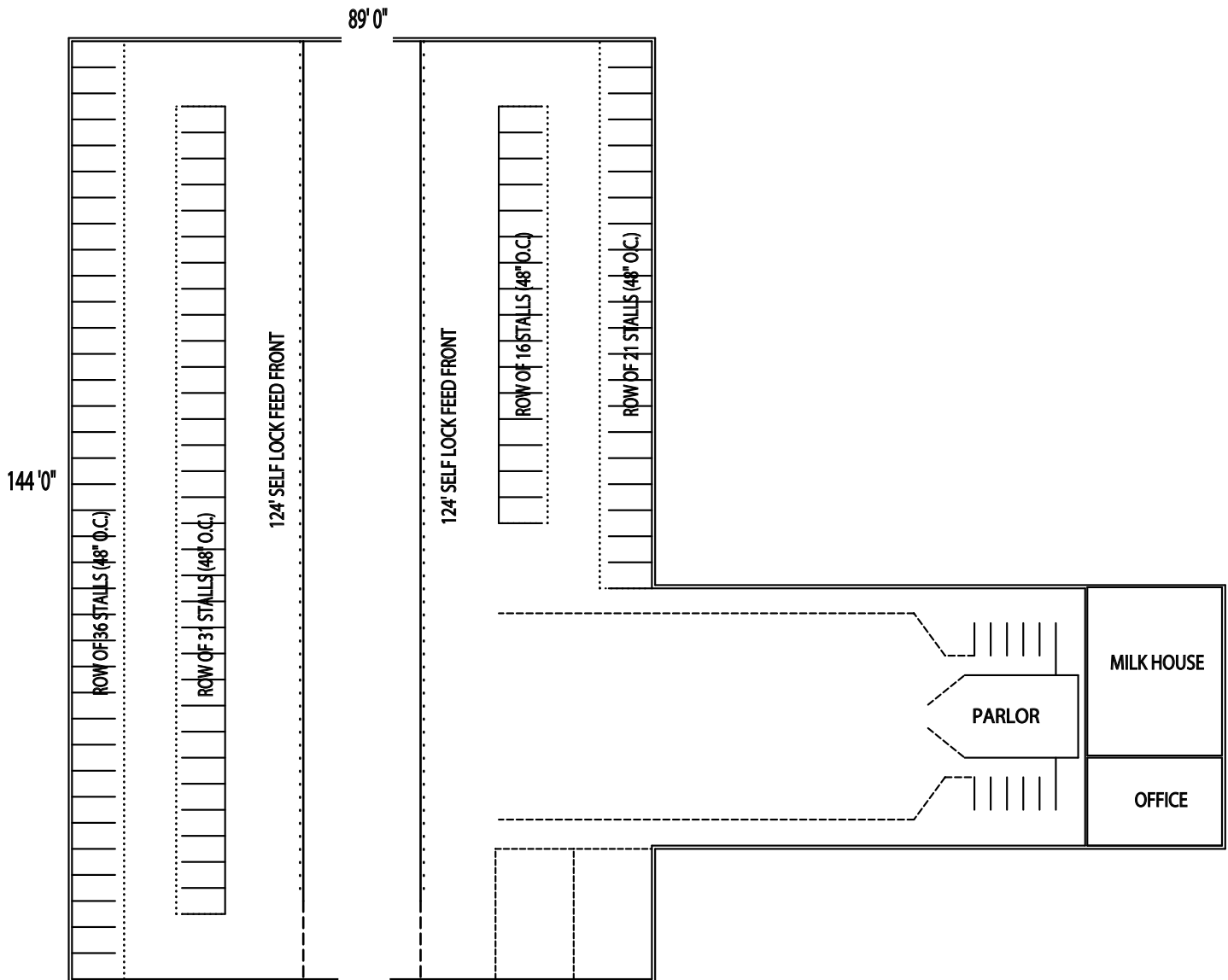

- 100 STALLS (SUSPENDED)
- LOCKOUT SELF LOCK
- MATERNITY + CALF PENS
- SLATTED ALLEYS
- DRIVE THRU MANGER
- COMFY CUSHION COW MATS

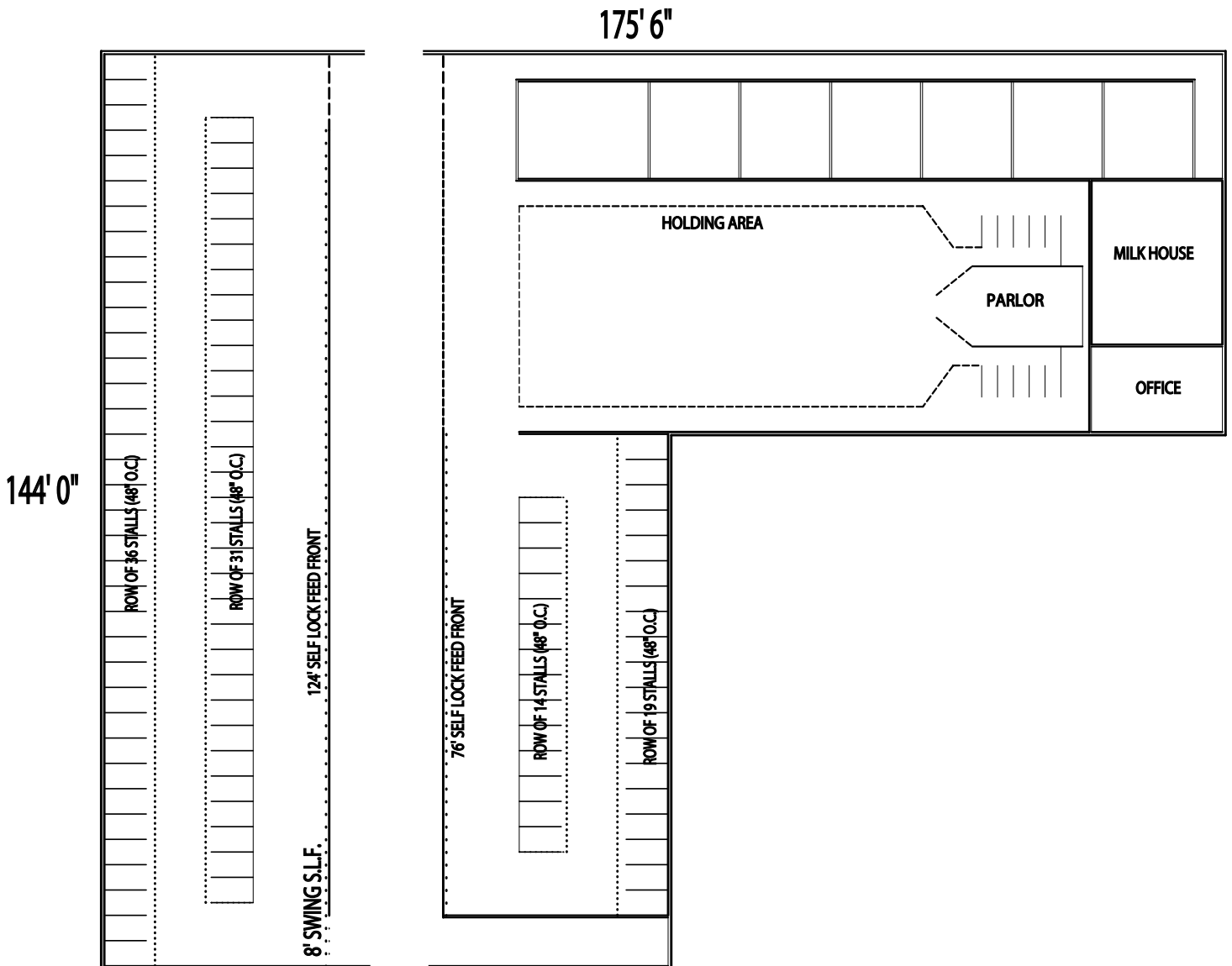

- 104 STALLS (SUSPENDED)
- COMFY CUSHION COW MATS
- SLATTED FLOORS
- DOUBLE 9 PARLOR

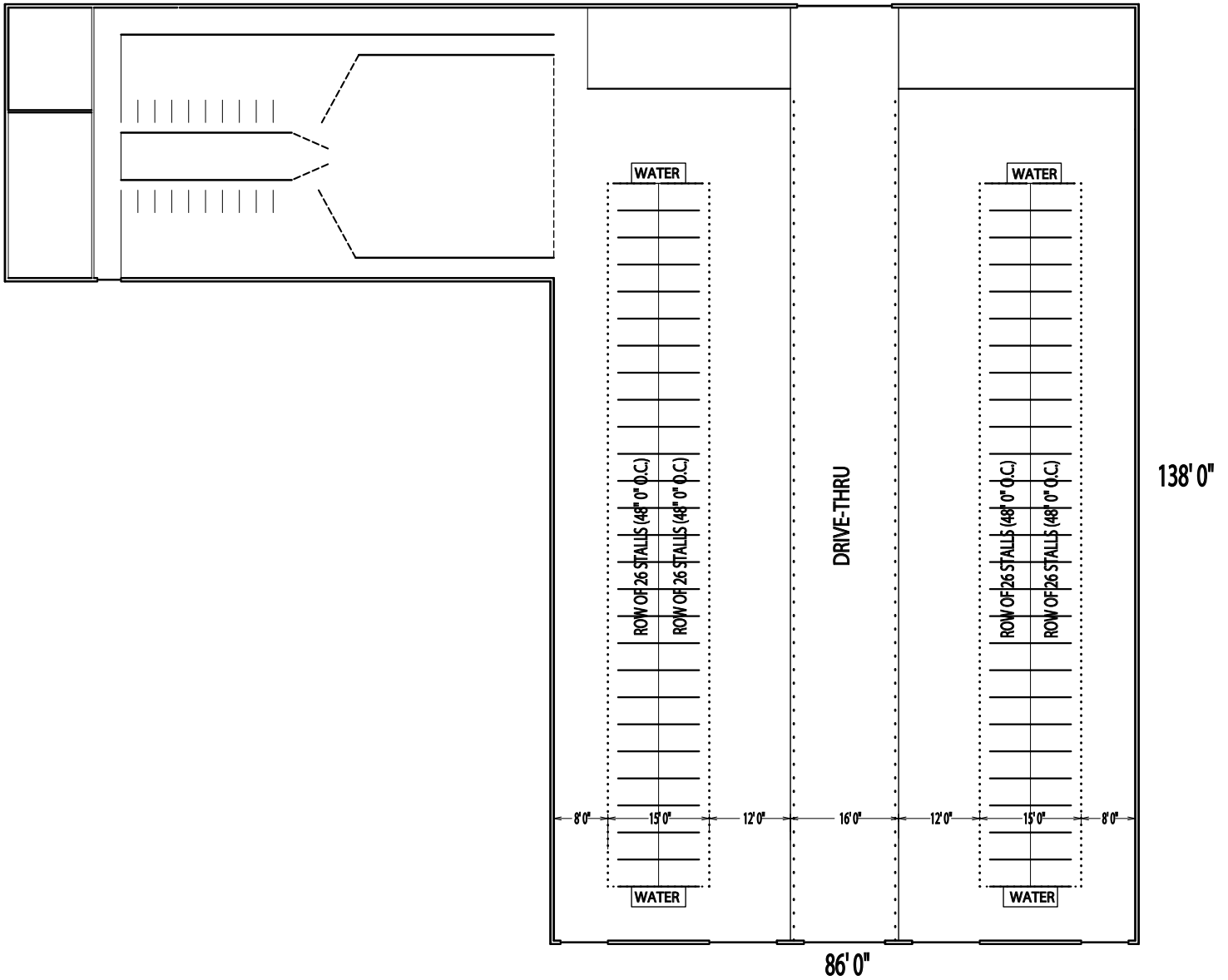

- SUSPENDED FREESTALLS
- COMFY CUSHION COW MATS
- SCRAPERS
- DOUBLE 6 MILKING PARLOR
- MANGER HEADRAIL PIPE

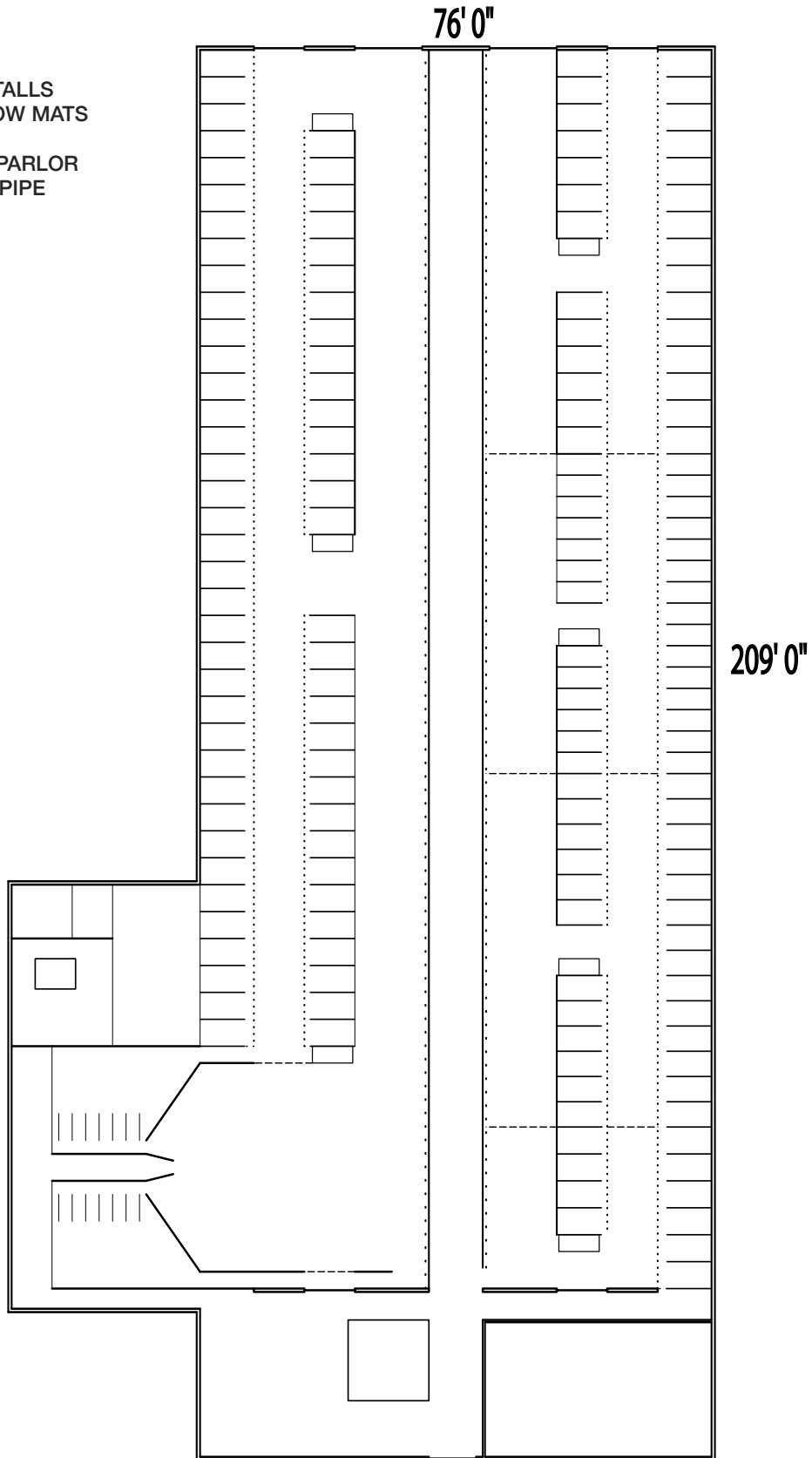

- 92 STALLS (SUSPENDED)
- LOCKOUT SELF LOCK
- SCRAPE ALLEYS
- DOUBLE 5 PARLOR (ONLY 8)

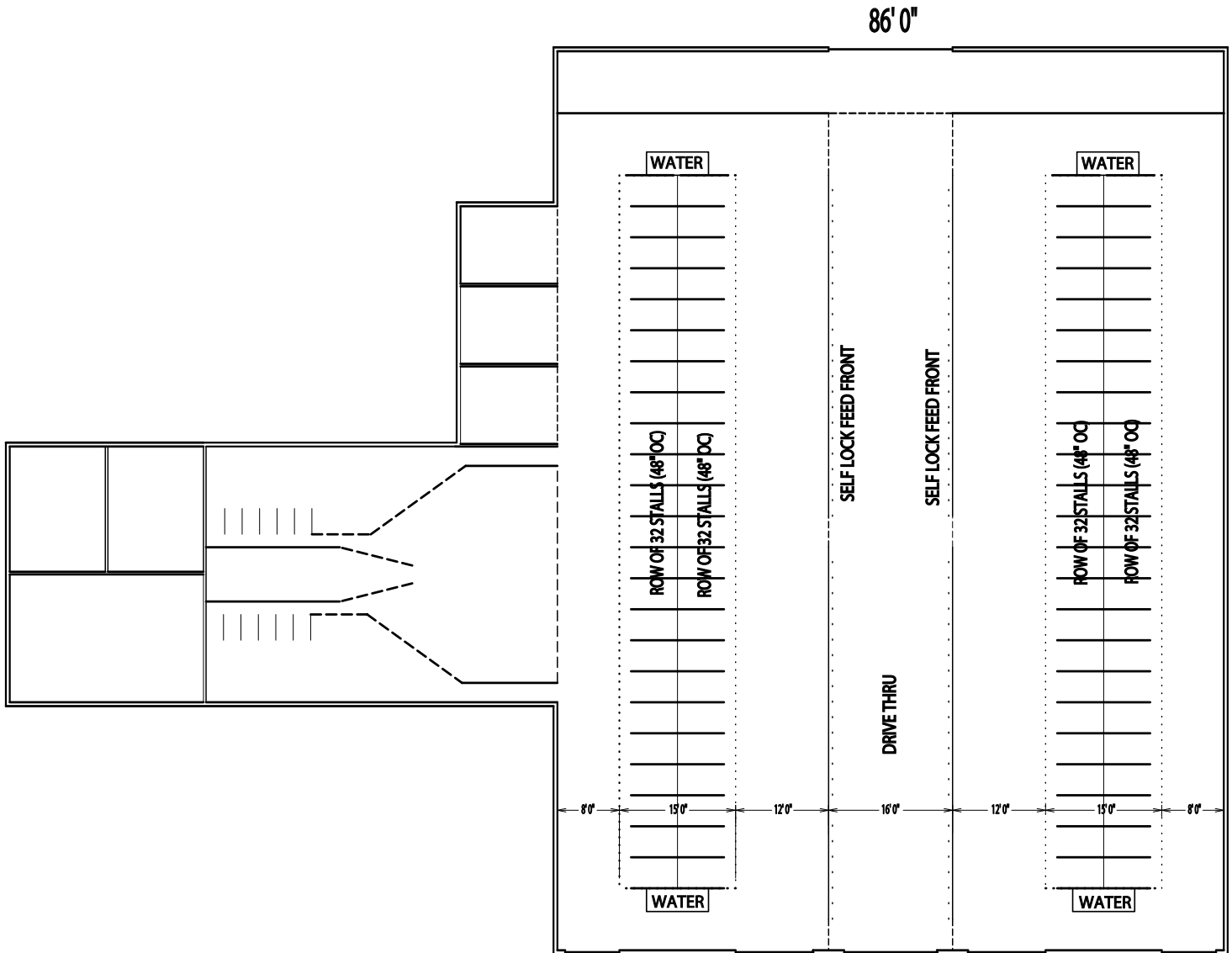

11

- 285 SUSPENDED FREESTALLS
- COMFY CUSHION COW MAT
- ANGLED SELF LOCK PANIC RELEASE

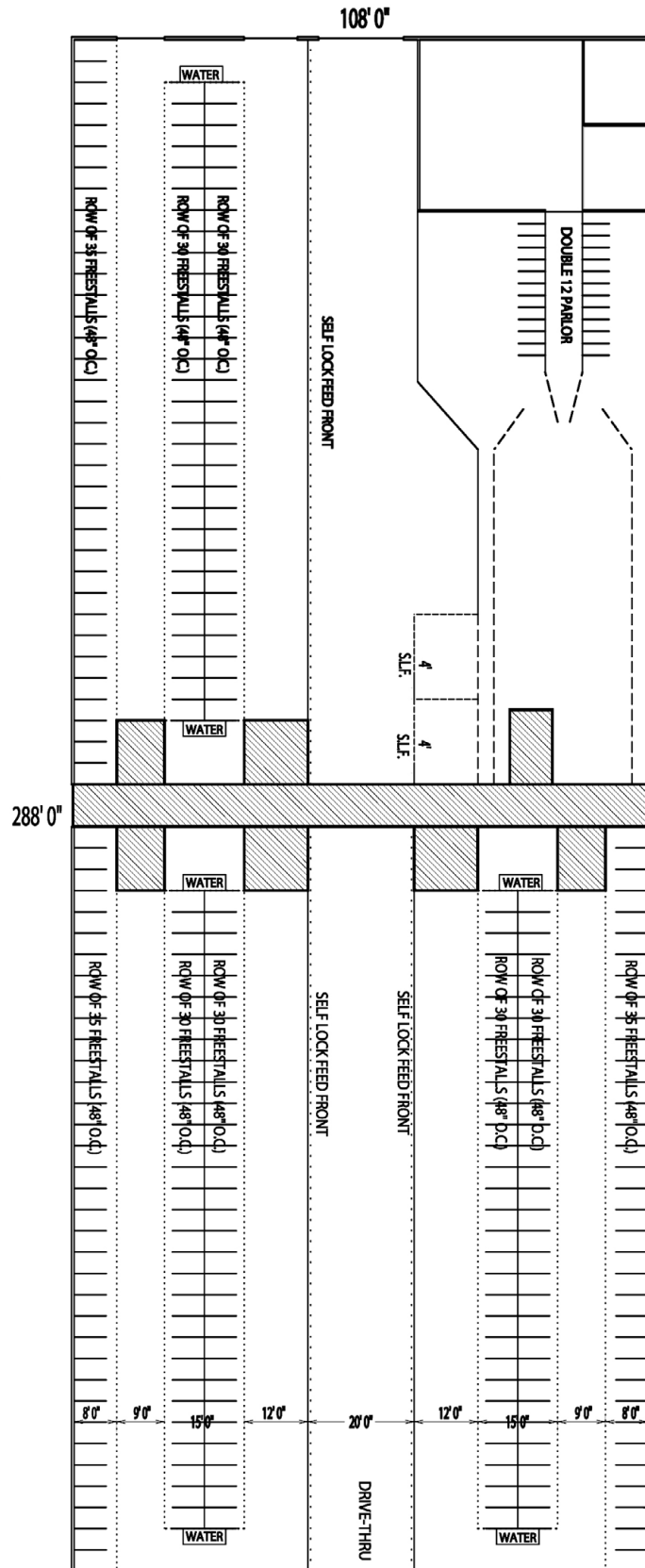

- 59 SUSPENDED FREESTALLS
- ANGLED SELF LOCK
- BRISKET BRACKETS
- ALLEY SCRAPERS
- PARALLEL PARLOR

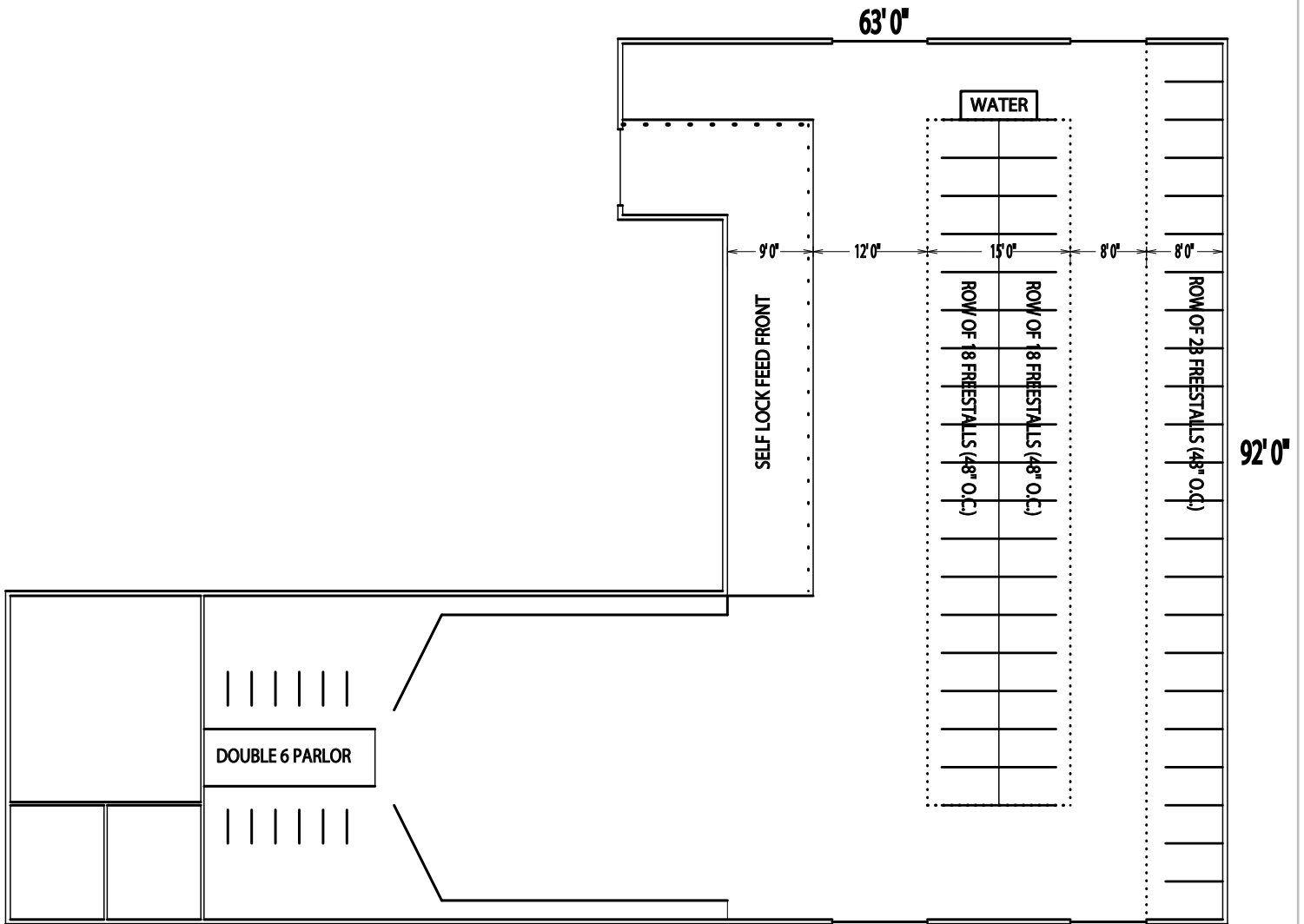

CROSS SECTIONS OF TYPICAL FREESTALL BARNS

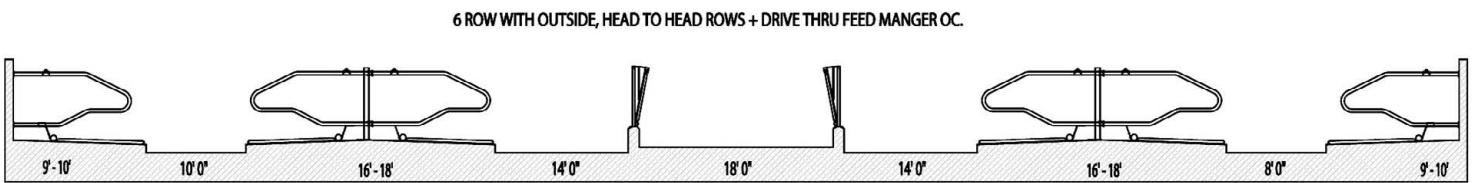
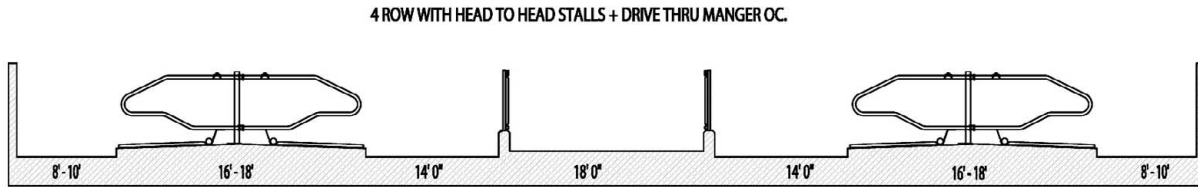
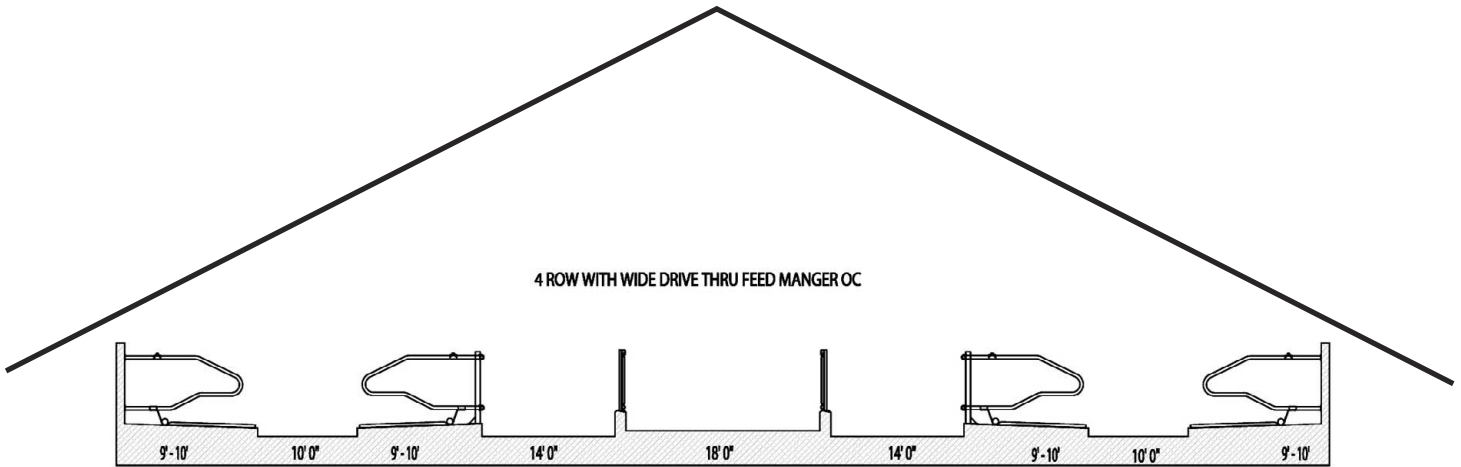

TYPICAL SPACE REQUIREMENTS

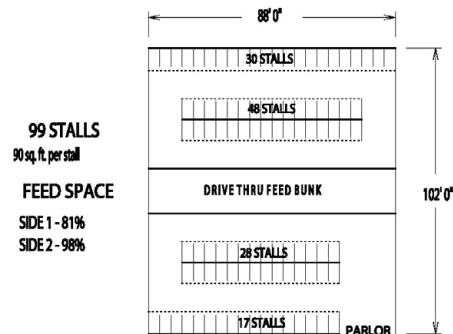
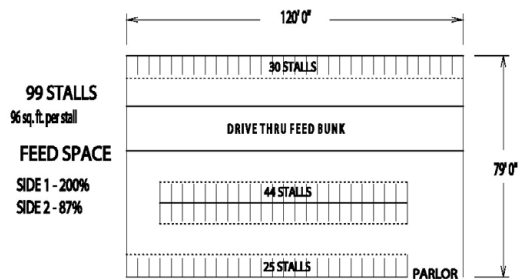
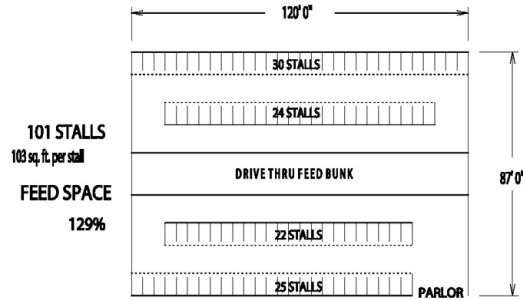
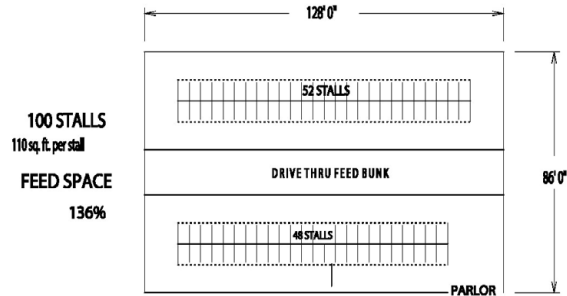
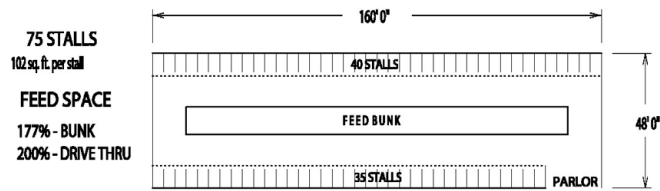

Herd size = total cows	40	75	100	250
Calves and heifers	.40	75	100	250
0-2 months	.3	6	8	20
3-5 months	.5	9	12	31
6-8 months	.5	10	12	31
9-12 months	.7	13	18	43
13-15 months	.5	9	12	30
16-24 months	.15	28	38	95
Dry cows	.7	13	17	42
Transition (first 4-14 days)	.0-3	0-4	1-5	4-9
Next 40 days+ (Divide into two groups)	.4-5	809	11-12	28-30
Close-up (2-3 weeks prepartum)	.1-3	3-5	4-6	8-14
Maternity (individual pens)	.2-3	3-5	4-6	10-16
Fresh cows (from 3 to 7 days postpartum)	.0-2	0-3	1-4	2-5
2-year-olds (300 days+)	.9-12	18-24	26-30	65-75
3 years and older (300 days+)	.23	42	58	145
High producers (120 days or less)	.8-9	15-18	20-24	56-60
Medium producers	.7-8	12-15	15-18	40-45
Low producers	.7-8	12-15	15-18	40-45
Sick cows	.0-2	0-4	0-5	0-12

** Numbers assume uniform calving year-around, 12 months calving interval, all males sold at birth and a 30 percent culling rate.

HEIFER SIZE & WEIGHT			FREESTALLS					SELF LOCK FEED FRONTS					
Approx. Age (months)	Approx. Weight (lbs)	Height To Top Of Back	Freestall Arch Length	PLATFORM LENGTH		Stall Width (o.c.)	(iii) Brisket Locator	(iv) Neckrail	(v) Stall Height	Total Height (Cow Side)	(vi) CURB HEIGHT		Type of Self Lock
				Single Stalls	Double Stalls						Cow Side	Feed Side	
Birth	100												
1	150	41"	48"	55"	106"	26"	40"-43"	39"-41"	35"	44"	10"	5"	Adj. Calf
2	200												
3	275	41"	48"	55"	106"	27"	42"-45"	41"-43"	36"	46"	10"	5"	Adj. Calf
4	350	42"	48"	55"	106"	28"	44"-47"	43"-45"	37"	46"	12"	7"	Adj. Calf
5	400	44"	48"	56"	111"	30"	45"-48"	44"-46"	37"	48"	12"	7"	Adj. Calf
6	450	48"	48"	57"	111"	31"	47"-50"	46"-48"	40"	48"	12"	7"	Adj. Calf
7	500	49"	48"	58"	111"	31"	49"-52"	47"-49"	42"	50"	15"	11"	Adj. SLF
8	550	49"	60"	67"	132"	32"	50"-53"	48"-50"	42"	50"	15"	11"	Adj. SLF
9	600	50"	60"	67"	132"	33"	52"-54"	50"-52"	43"	50"	15"	11"	Adj. SLF
10	700	50"	60"	68"	134"	35"	52"-55"	54"-56"	43"	50"	15"	11"	Adj. SLF
11	750	51"	60"	72"	136"	36"	56"-59"	54"-56"	44"	52"	15"	11"	Adj. SLF
12 (i)	800	51"	60"	72"	136"	37"	56"-59"	55"-58"	44"	52"	15"	11"	Adj. SLF
13 (i)	850	52"	60"	72"	139"	38"	57"-60"	57"-59"	44"	52"	15"	11"	Adj. SLF
14 (i)	900	53"	72"	84"	139"	39"	58"-62"	58"-61"	45"	54"	15"	11"	Adj. SLF
15 (i)	950	55"	72"	84"	159"	40"	58"-62"	59"-62"	45"	54"	15"	11"	Adj. SLF
16	1010	55"	72"	86"	159"	40"	59"-62"	59"-62"	46"	56"	15"	11"	Adj. SLF
17	1060	55"	72"	86"	163"	42"	60"-64"	60"-64"	46"	56"	18"	14"	Adj. SLF
18	1120	56"	72"	90"	163"	42"	60"-64"	60"-64"	46"	58"	19"	14"	Cow
19	1150	56"	72"	90"	166"	44"	62"-65"	64"-68"	47"	58"	19"	14"	Cow
20	1190	58"	72"	96"	166"	44"	64"-67"	64"-68"	47"	60"	19"	14"	Cow
21	1230	60"	79"	100"	175"	46"	65"-68"	66"-70"	48"	60"	19"	14"	Cow
22	1270	60"	79"	100"	175"	46"	70"-72"	70"-72"	48"	60"	19"	14"	Cow
23	1310	60"	79"	102"	180"	46"	70"-72"	70"-72"	48"	61"	19"	14"	Cow
24 (ii)	1350	60"	79"	102"	180"	47"	70"-72"	70"-72"	49"	61"	19"	14"	Cow
Cows (std.)	85" loop	58"-60"	88"	108"	192"	48" +	70"	70"-72"	49"-51"	62"-63"	19"	14"	Cow
Cows (std.)	94" loop	58"-60"	96"	120"	216"	50"-52"	70"	70"-72"	50"-52"	62"-63"	19"	14"	Cow

USE CALF PENNING FOR ANIMALS UNDER 200 LBS. (See Calf Suites Section)

GUIDELINES ONLY! MUST INSTALL FREESTALLS TO MATCH ANIMAL SIZE

- i = breeding age
- ii = calving age
- iii = horizontal distance from rear of platform to bottom of brisket bracket
- iv = horizontal distance from rear of platform to o.c. neckrail
- v = stall height from top of compressed bedding (or mat) to bottom of headrail
- vi = 1 1/2" space between curb and bottom pipe of SLF
- * new recommendations for 1600 lb. + cows (must use 101169-10 clamp for 85" & 94" loops)

SPREAD DIVIDERS TO MATCH THE INSTALLATION HEIGHTS GIVEN

