



# DPL-DD SERIES

Direct Drive Flat Blade & Air Foil Blade Plenum Fans

## PERFORMANCE SPECIFICATIONS

MODEL	CLASS	1" SP	3" SP	5" SP	7" SP	9" SP
DPL-12DD	II	4300	4000	3600	3000	--
DPL-13DD	II	5200	4700	4000	3000	--
DPL-15DD	II	5900	5200	4200	2800	--
DPL-16DD	II	7600	6800	5700	4200	--
DPL-18DD	I	7200	6400	2400	--	--
DPL-AF-18DD	II	9500	8500	7500	6500	4300
DPL-20DD	I	8800	7600	5200	--	--
DPL-AF-20DD	II	11500	10500	9000	7200	5000
DPL-22DD	I	12000	9500	4500	--	--
DPL-AF-22DD	II	14500	13000	11000	9000	7000
DPL-24DD	I	14000	12500	8000	--	--
DPL-AF-24DD	II	16000	14000	12000	9000	6500
DPL-27DD	I	16000	14000	9000	--	--
DPL-AF-27DD	II	20000	17000	15000	11500	8000
DPL-30DD	I	20000	18000	12000	--	--
<del>DPL-AF-30DD</del>	II	25000	22000	18000	15000	10000
DPL-33DD	I	26000	22000	16000	--	--
<del>DPL-AF-33DD</del>	II	31000	28000	24000	20000	16000
DPL-36DD	I	30000	26000	20000	--	--
<del>DPL-AF-36DD</del>	II	38000	32000	26000	20000	15000

Power rating (BHP) does not include transmission losses. Performance certified is for installation type B: Free inlet, Ducted outlet. Performance ratings do not include the effect of appurtenances (accessories).

CFM values listed above are summarized for convenience.

**\*DPL-AF-30DD, 33DD and 36DD currently under redesign. Please call factory.**

FOR FAN CURVES & FULL PERFORMANCE DATA, CONSULT OUR DELAIR SOFTWARE. DOWNLOAD DELAIR @ [WWW.CANARM.COM/DELAIR](http://WWW.CANARM.COM/DELAIR)

## FEATURES

- Bolted, 4 piece, galvanized frame construction
- Full Class II capability (select models)
- Standard welded backward inclined flat blade wheel for DPL-12DD to DPL-36DD (aluminum wheel available as option)
- Standard welded aluminum backward inclined airfoil wheel for DPL-AF-18DD to DPL-AF-27DD

## DIMENSIONS

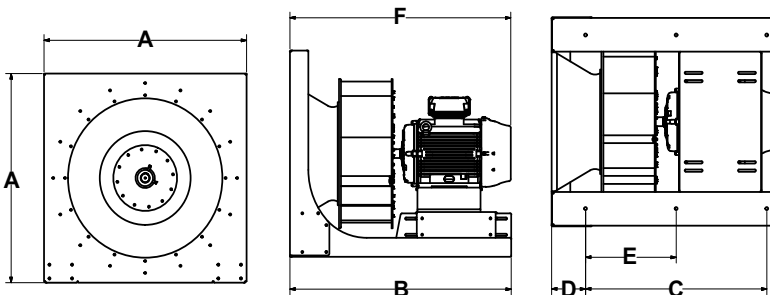

MODEL	A	B	C	D	E	F	UNIT WEIGHT (LBS) (without motor & drives)
DPL-12DD	18"	21"	16"	2 1/2"	N/A	N/A	51
DPL-13DD	18"	21"	16"	2 1/2"	N/A	N/A	57
DPL-15DD	22"	24"	16"	4"	N/A	N/A	68
DPL-16DD	22"	24"	16"	4"	N/A	N/A	80
DPL-18DD & DPL-AF-18DD	26 1/2"	29 1/2"	20"	6"	N/A	N/A	91
DPL-20DD & DPL-AF-20DD	26 1/2"	30"	20"	6"	N/A	N/A	104
DPL-22DD & DPL-AF-22DD	33 1/2"	34"	26"	6"	N/A	N/A	148
DPL-24DD & DPL-AF-24DD	33 1/2"	37"	26"	8"	N/A	N/A	185
DPL-27DD & DPL-AF-27DD	38"	40 1/8"	32"	6"	16"	N/A	205
DPL-30DD & <del>DPL-AF-30DD</del>	38"	42 1/8"	34"	6"	17"	N/A	248
DPL-33DD & <del>DPL-AF-33DD</del>	48"	44 1/8"	37"	4"	18 1/2"	N/A	306
DPL-36DD & <del>DPL-AF-36DD</del>	48"	47 5/8"	40"	4"	21"	N/A	357

\* F dimension dependent on motor frame.

\*\*DPL-AF-30DD, 33DD and 36DD currently under redesign. Please call factory.

## OPTIONS

- Inlet guard
- Wheel guard
- Piezometers
- Vibration isolators

## ACCESSORIES

- Dwyer differential pressure controller

## OTHER AVAILABLE MODELS

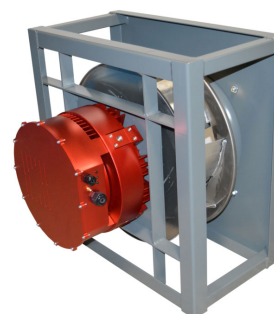

ADPL



DPLH