

AXC SERIES - INLINE DUCT FANS



FEATURES

- Maintenance free and energy efficient external rotor motor.
- Handles high static pressure.
- Backward curved impellers which greatly reduce operating noise levels.
- Completely speed controllable.
(See MC series controls on page K3 in Controls & Thermostats section).
- Heavy gauge drawn steel housing epoxy coated inside and out for superior corrosion protection.

DIMENSIONS

MODEL	D	d	a	B
AXC100A-ES	9.5"	3.9"	1.0"	8.3"
AXC100B	9.5"	3.9"	1.0"	8.3"
AXC125A-ES	9.5"	4.8"	1.0"	8.3"
AXC125B	9.5"	4.8"	1.0"	8.3"
AXC150A-ES	9.5"	5.8"	1.0"	8.3"
AXC150B-ES	13.2"	5.8"	1.0"	9.1"
AXC200A-ES	13.2"	7.8"	1.0"	9.1"
AXC200B-ES	13.2"	7.8"	1.0"	9.1"
AXC250-ES	13.2"	9.8"	1.0"	9.1"
AXC300A-ES	15.9"	11.8"	1.2"	11.8"
AXC300B-ES	15.9"	11.8"	1.2"	11.8"

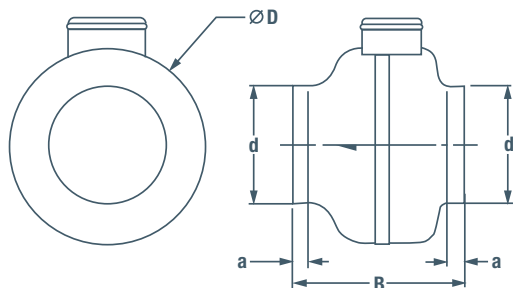

The quiet and efficient backward curved impeller is capable of developing significant pressure and the in-line configuration simplifies installation.

The unique motor design, combined with high quality materials and workmanship, result in a truly versatile fan.

Use Canarm the AXC series fans to supplement your dryer's fan and enhance your dryer's performance. AXC fans have an exclusive combination of design features resulting in a powerful, quiet unity that is unmatched by other designs.

Better ventilation solutions include powerful AXC series fans for range hoods. These remote-mounted fans improve the efficiency of range hoods, while reducing noise. The exclusive combination of design features delivers a powerful, yet quiet, fan that is unmatched by other range hood exhaust systems.

PERFORMANCE DATA

MODEL	DIAMETER	VOLTS	AMPS (FLA)	WATTS	RPM	dB(A) @ 1M	ENERGY STAR	WEIGHT (lbs)	CFM @ STATIC PRESSURE									
									0" SP	0.2" SP	0.4" SP	0.6" SP	0.8" SP	1.0" SP	1.2" SP	1.5" SP	2.0" SP	3.0" SP
AXC100A-ES	4"	120	0.36	43.3	2580	44	Yes	7	147	130	107	82	57	34	11	-	-	-
AXC100B	4"	120	0.69	83.4	2620	54	No	7	150	140	127	112	94	74	53	23	-	-
AXC125A-ES	5"	120	0.37	62	1650	47	Yes	7	179	150	121	87	49	14	-	-	-	
AXC125B	5"	120	0.7	85.4	2750	53	No	7	183	160	141	122	101	77	51	14	-	-
AXC150A-ES	6"	120	0.4	46.8	2390	51	Yes	7	235	190	148	97	44	-	-	-	-	
AXC150B-ES	6"	120	0.74	89.2	2450	49	Yes	11	308	260	216	175	139	108	81	47	-	-
AXC200A-ES	8"	120	0.7	84.5	2550	56	Yes	11	368	300	234	184	149	114	70	-	-	
AXC200B-ES	8"	120	1.6	188	2550	58	Yes	11	579	520	453	387	329	282	245	206	154	-
AXC250-ES	10"	120	1.6	197	2470	59	Yes	11	616	550	488	431	379	330	286	227	143	-
AXC300A-ES	12"	120	1.8	206	2450	62	Yes	18	780	700	595	420	330	290	255	210	132	-
AXC300B-ES	12"	120	2.6	312	2780	65	Yes	20	970	910	803	680	559	453	367	273	164	-

ACCESSORIES

FAN SIZE	BACKDRAFT DAMPER	MOUNTING CLAMPS	EXHAUST & SUPPLY GRILLS
4"	BD100	MC100	GR100
5"	BD125	MC125	GR150
6"	BD150	MC150	GR150
8"	BD200	MC200	GR200
10"	BD250	MC250	-
12"	BD300	MC300	-
14"	BD355	MC355	-



MOUNTING CLAMPS



BACKDRAFT DAMPERS



EXHAUST & SUPPLY GRILL



SENSORS



CONTROL TIMERS



AXC models are special non-stock items and cannot be returned or cancelled.